

CLIENT
Toronto Community Housing Corporation (TCHC) and 2747199 Ontario Limited (Deltera Inc.)

THIS DRAWING IS BASED ON DIMENSIONAL SURVEY INFORMATION PROVIDED BY OTHERS AND REPRESENTS THE ARCHITECT'S BEST CURRENT UNDERSTANDING OF EXISTING CONDITIONS. THE ARCHITECT CANNOT ACCEPT RESPONSIBILITY FOR THE ACCURACY OF THIS SURVEY INFORMATION.
 ALL DIMENSIONS ARE SHOWN IN METRIC. DO NOT SCALE FROM THIS DRAWING.
 THIS DRAWING REMAINS THE COPYRIGHT OF KARAKUSEVIC CARSON ARCHITECTS AND MAY NOT BE USED WITHOUT THEIR EXPRESSED WRITTEN CONSENT.
THESE DRAWINGS ARE NOT FOR CONSTRUCTION

NOTES
 FOR LANDSCAPE DETAILS REFER TO DRAWINGS BY PFS.
 FOR PARKING AND LOADING OPERATION REFER TO DRAWINGS BY BA GROUP.

- Phases 4&5 Property Line
- City of Toronto Owned Lands Right of Way
- Ancillary

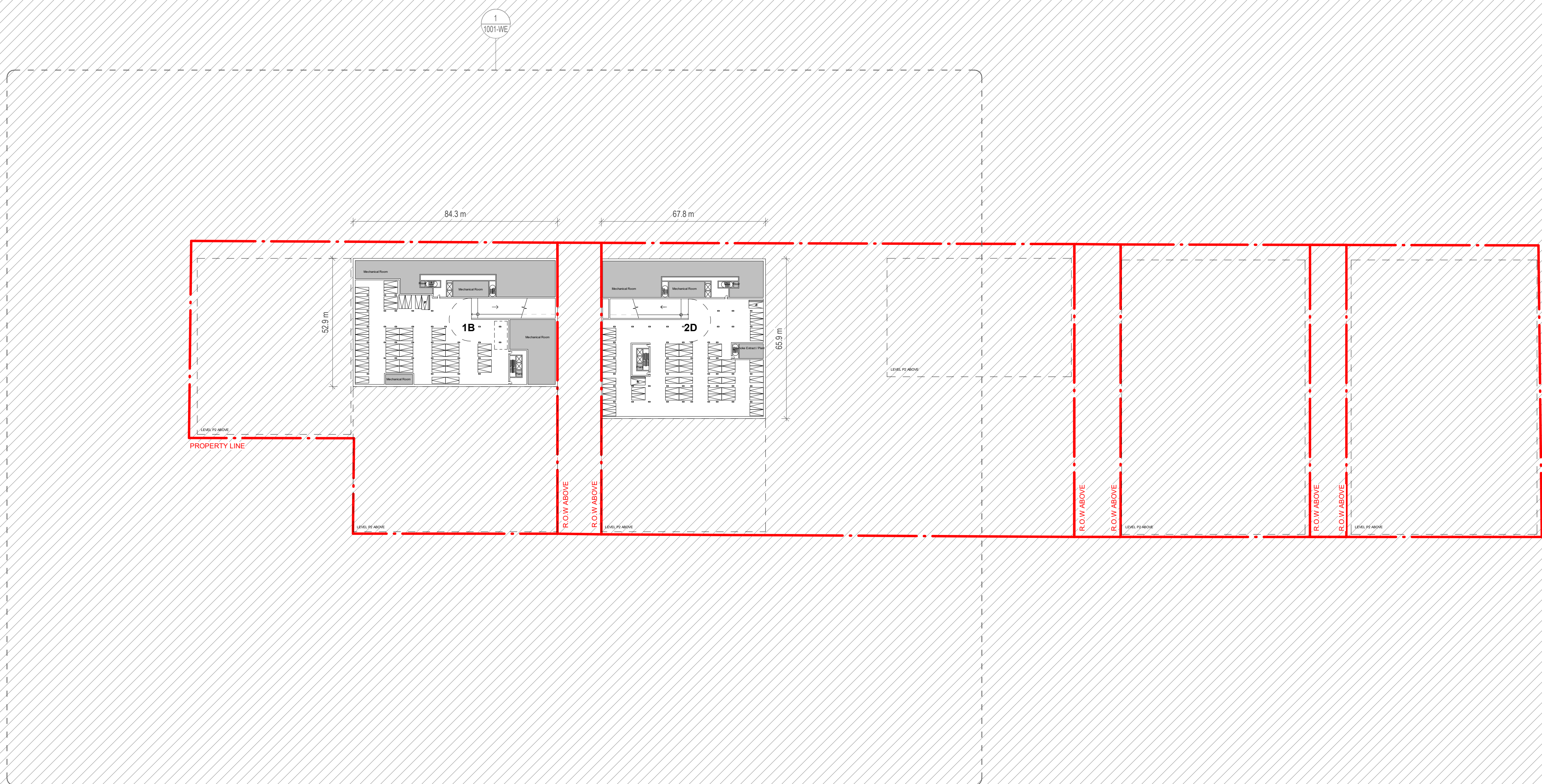

Rev	Status	Reason for Issue	Date
P03	S4	P2 - Issued for ZBA	11/29/22
P02	S3	P2 - Draft for Client Review	11/15/22
P01	S4	P1 - Issued for ZBA	04/14/22
P00	S3	P1 - Draft for Client Review	04/01/22

ARCHITECT OF RECORD
E.R.A. Architects Inc.
 625 Church St
 Suite 600
 Toronto
 Ontario, M4Y 2G1
 info@eraarch.ca | 416 963 4497



DESIGN
Karakusevic Carson Architects
 Studio 501
 37 Cremer St
 Hackney
 London E2 8HD
 mail@karakusevic-carson.com | +44(0)207 566 6500

PROJECT
Regent Park Phases 4 & 5

TITLE
Level P3 Plan

DRAWING NUMBER	REVISION	
577 - KCA-XX-P3-DR-A - 1001	P03	
STATUS	STAGE	
S4 - Suitable for stage approval	P2	
REVISION DATE	DRAWN BY	SCALE
11/29/22	H/A/J	1 : 1000 @ ARCH D
FIRST ISSUED	CHECKED BY	KCA PROJECT NUMBER
04/01/22	PK/RM	577

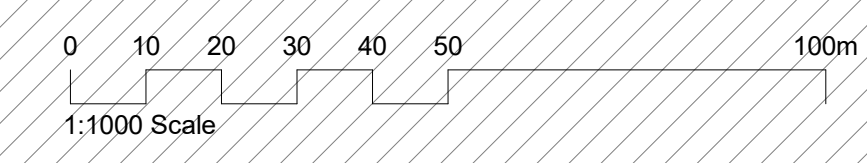

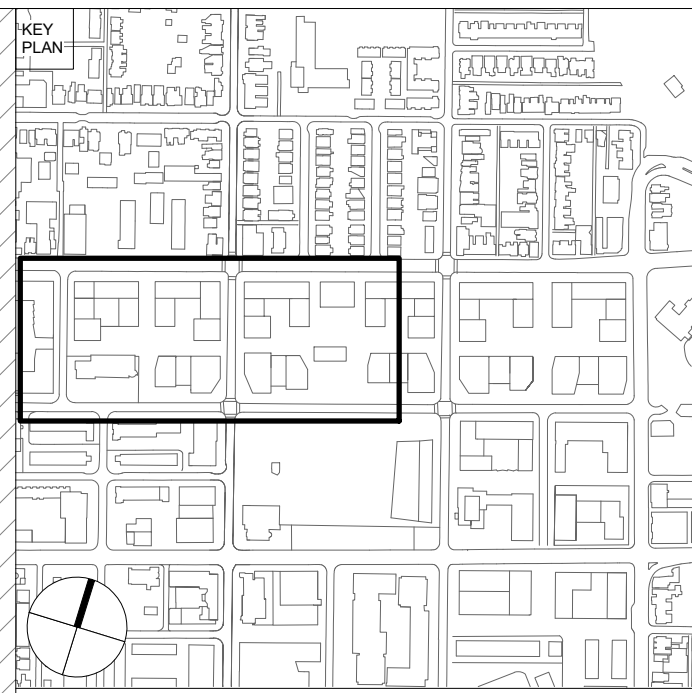

CLIENT
Toronto Community Housing Corporation (TCHC) and 2747199 Ontario Limited (Deltera Inc.)

THIS DRAWING IS BASED ON DIMENSIONAL SURVEY INFORMATION PROVIDED BY OTHERS AND REPRESENTS THE ARCHITECT'S BEST CURRENT UNDERSTANDING OF EXISTING CONDITIONS. THE ARCHITECT CANNOT ACCEPT RESPONSIBILITY FOR THE ACCURACY OF THIS SURVEY INFORMATION.
 ALL DIMENSIONS ARE SHOWN IN METRIC. DO NOT SCALE FROM THIS DRAWING.
 THIS DRAWING REMAINS THE COPYRIGHT OF KARAKUSEVIC CARSON ARCHITECTS AND MAY NOT BE USED WITHOUT THEIR EXPRESSED WRITTEN CONSENT.
THESE DRAWINGS ARE NOT FOR CONSTRUCTION

NOTES
 FOR LANDSCAPE DETAILS REFER TO DRAWINGS BY PFS.
 FOR PARKING AND LOADING OPERATION REFER TO DRAWINGS BY BA GROUP.

- Phases 4&5 Property Line
- City of Toronto Owned Lands Right of Way
- Ancillary

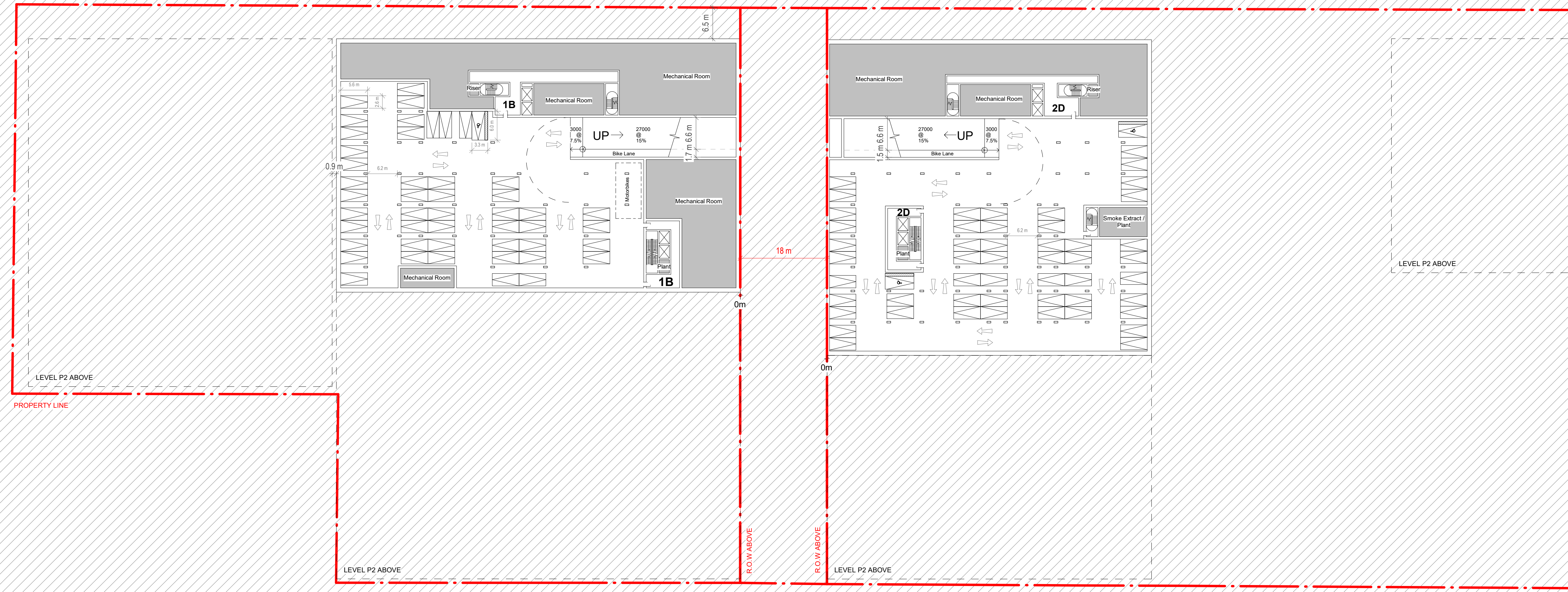

P03	S4	P2 - Issued for ZBA	11/29/22
P02	S3	P2 - Draft for Client Review	11/15/22
P01	S4	P1 - Issued for ZBA	04/14/22
P00	S3	P1 - Draft for Client Review	04/01/22

ARCHITECT OF RECORD
E.R.A. Architects Inc.
 625 Church St
 Suite 600
 Toronto
 Ontario, M4Y 2G1
 info@eraarch.ca | 416 963 4497



DESIGN
Karakusevic Carson Architects
 Studio 501
 37 Cremer St
 Hackney
 London E2 8HD
 mail@karakusevic-carson.com | +44(0)207 566 6300

PROJECT
Regent Park Phases 4 & 5

TITLE
Level P3 Plan - West

DRAWING NUMBER	REVISION	
577 - KCA-WE-P3-DR-A - 1001	P03	
STATUS	STAGE	
S4 - Suitable for stage approval	P2	
REVISION DATE	DRAWN BY	SCALE
11/29/22	H/AJAN	1 : 500 @ ARCH D
FIRST ISSUED	CHECKED BY	KCA PROJECT NUMBER
04/01/22	PK/RM	577

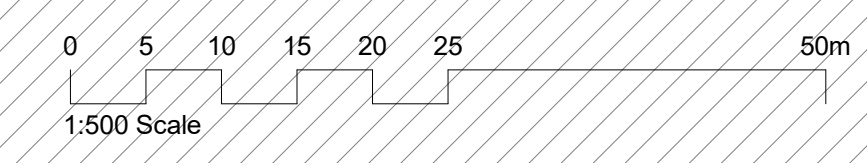

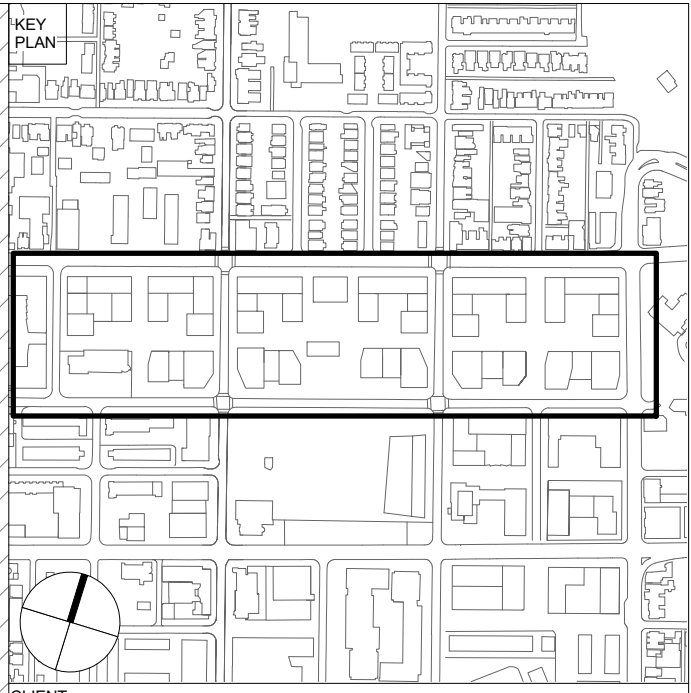

CLIENT
Toronto Community Housing Corporation (TCHC) and 2747199 Ontario Limited (Deltra Inc.)

THIS DRAWING IS BASED ON DIMENSIONAL SURVEY INFORMATION PROVIDED BY OTHERS AND REPRESENTS THE ARCHITECT'S BEST CURRENT UNDERSTANDING OF EXISTING CONDITIONS. THE ARCHITECT CANNOT ACCEPT RESPONSIBILITY FOR THE ACCURACY OF THIS SURVEY INFORMATION.
 ALL DIMENSIONS ARE SHOWN IN METRIC. DO NOT SCALE FROM THIS DRAWING.
 THIS DRAWING REMAINS THE COPYRIGHT OF KARAKUSEVIC CARSON ARCHITECTS AND MAY NOT BE USED WITHOUT THEIR EXPRESSED WRITTEN CONSENT.
THESE DRAWINGS ARE NOT FOR CONSTRUCTION

NOTES
 FOR LANDSCAPE DETAILS REFER TO DRAWINGS BY PFS.
 FOR PARKING AND LOADING OPERATION REFER TO DRAWINGS BY BA GROUP.

- Phases 4&5 Property Line
- City of Toronto Owned Lands Right of Way
- Ancillary

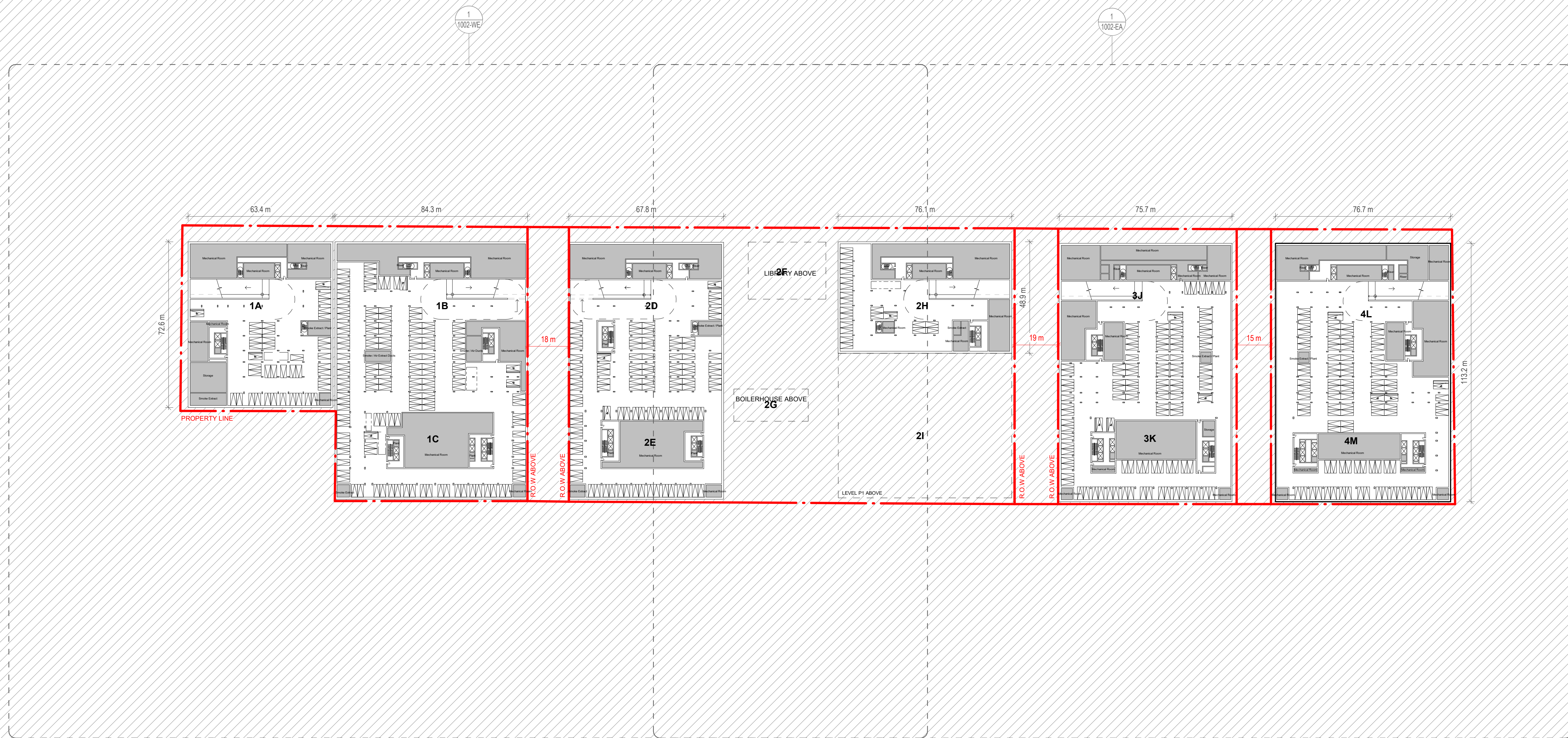

P03	S4	P2 - Issued for ZBA	11/29/22
P02	S3	P2 - Draft for Client Review	11/15/22
P01	S4	P1 - Issued for ZBA	04/14/22
P00	S3	P1 - Draft for Client Review	04/01/22

Rev. Status Reason for Issue Date

ARCHITECT OF RECORD

E.R.A. Architects Inc.
 625 Church St
 Suite 600
 Toronto
 Ontario, M4Y 2G1
 info@eraarch.ca | 416 963 4497



DESIGN

Karakusevic Carson Architects
 Studio 501
 37 Cremer St
 Hackney
 London E2 8HD
 mail@karakusevic-carson.com | +44(0)207 566 6300

PROJECT

Regent Park Phases 4 & 5

TITLE

Level P2 Plan

DRAWING NUMBER

577 - KCA-XX-P2-DR-A - 1002 P03

STATUS

S4 - Suitable for stage approval P2

REVISION DATE

11/29/22

FIRST ISSUED

04/01/22

DRAWN BY

HA/JAN

CHECKED BY

PK/RM

KCA PROJECT NUMBER

577

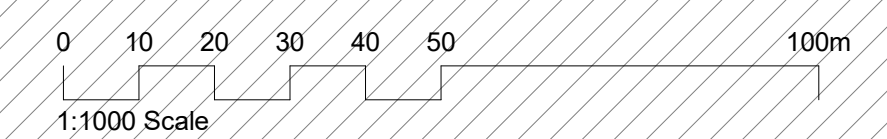

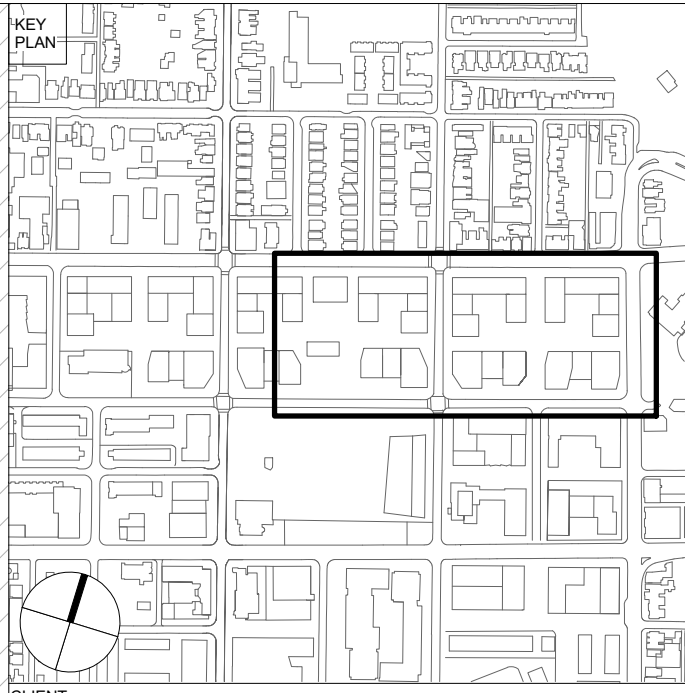

CLIENT
Toronto Community Housing Corporation (TCHC) and 2747199 Ontario Limited (Deltera Inc.)

THIS DRAWING IS BASED ON DIMENSIONAL SURVEY INFORMATION PROVIDED BY OTHERS AND REPRESENTS THE ARCHITECT'S BEST CURRENT UNDERSTANDING OF EXISTING CONDITIONS. THE ARCHITECT CANNOT ACCEPT RESPONSIBILITY FOR THE ACCURACY OF THIS SURVEY INFORMATION.
 ALL DIMENSIONS ARE SHOWN IN METRIC. DO NOT SCALE FROM THIS DRAWING.
 THIS DRAWING REMAINS THE COPYRIGHT OF KARAKUSEVIC CARSON ARCHITECTS AND MAY NOT BE USED WITHOUT THEIR EXPRESSED WRITTEN CONSENT.
THESE DRAWINGS ARE NOT FOR CONSTRUCTION

NOTES
 FOR LANDSCAPE DETAILS REFER TO DRAWINGS BY PFS.
 FOR PARKING AND LOADING OPERATION REFER TO DRAWINGS BY BA GROUP.

- Phases 4&5 Property Line
- City of Toronto Owned Lands Right of Way
- Ancillary

Rev	Status	Reason for Issue	Date
P03	S4	P2 - Issued for ZBA	11/29/22
P02	S3	P2 - Draft for Client Review	11/15/22
P01	S4	P1 - Issued for ZBA	04/14/22
P00	S3	P1 - Draft for Client Review	04/01/22

ARCHITECT OF RECORD
E.R.A. Architects Inc.
 625 Church St
 Suite 600
 Toronto
 Ontario, M4Y 2G1
 info@eraarch.ca | 416 963 4497



DESIGN
Karakusevic Carson Architects
 Studio 501
 37 Cremer St
 Hackney
 London E2 8HD
 mail@karakusevic-carson.com | +44(0)207 566 6300

PROJECT
Regent Park Phases 4 & 5

TITLE
Level P2 Plan - East

DRAWING NUMBER	REVISION	
577 - KCA-EA-P2-DR-A - 1002	P03	
STATUS	STAGE	
S4 - Suitable for stage approval	P2	
REVISION DATE	DRAWN BY	SCALE
11/29/22	H/AJAN	1 : 500 @ ARCH D
FIRST ISSUED	CHECKED BY	KCA PROJECT NUMBER
04/01/22	PK/RM	577

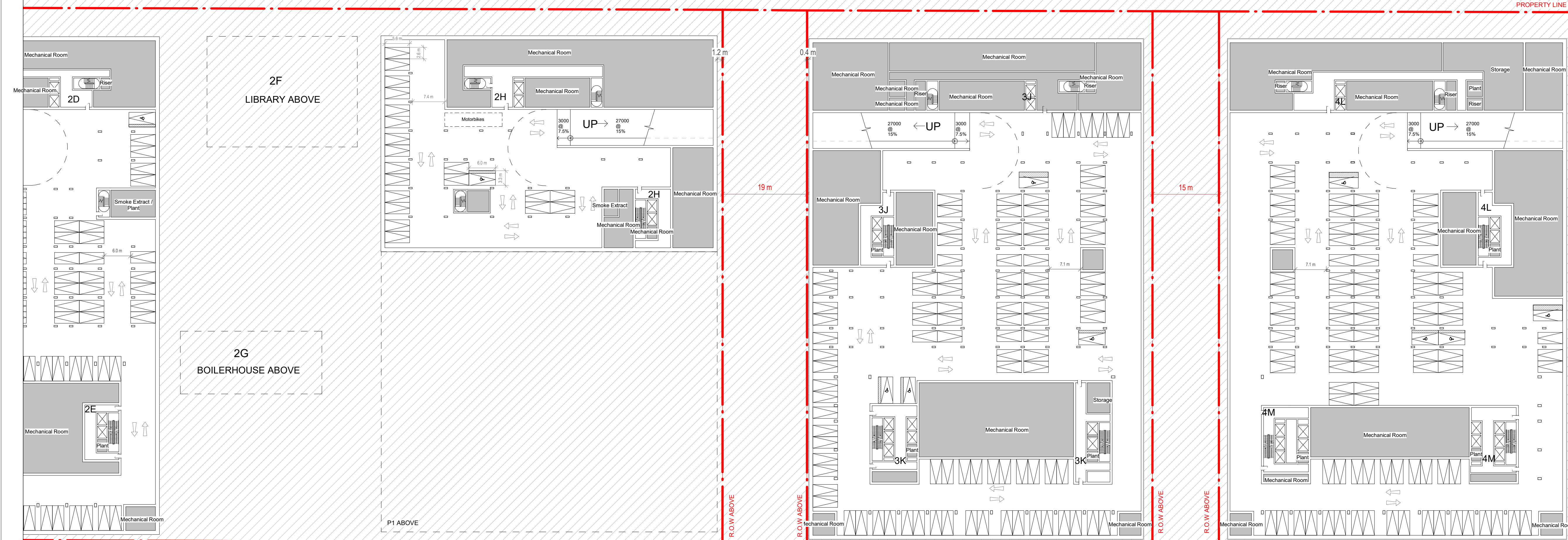
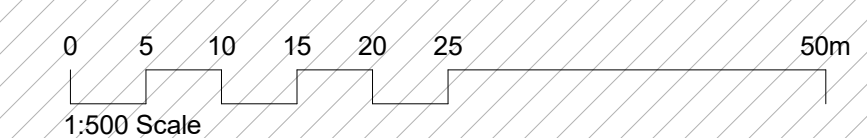

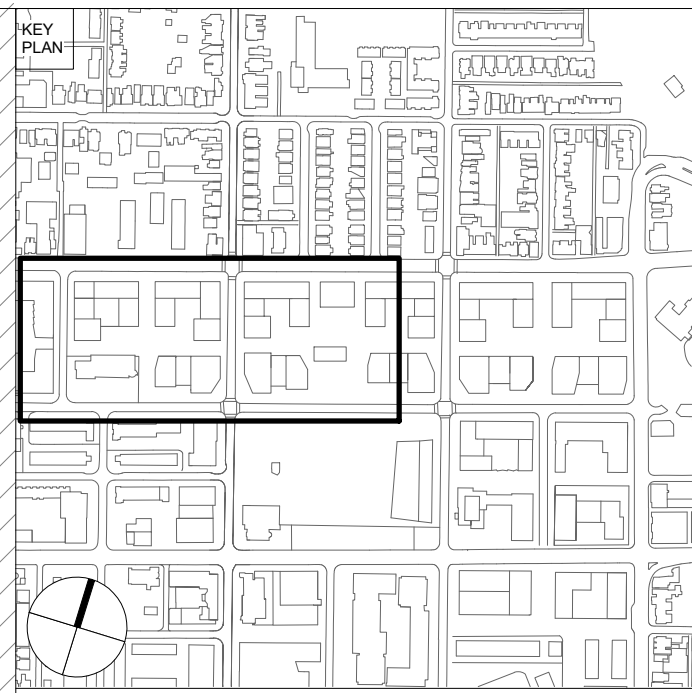

CLIENT
Toronto Community Housing Corporation (TCHC) and 2747199 Ontario Limited (Deltra Inc.)

THIS DRAWING IS BASED ON DIMENSIONAL SURVEY INFORMATION PROVIDED BY OTHERS AND REPRESENTS THE ARCHITECT'S BEST CURRENT UNDERSTANDING OF EXISTING CONDITIONS. THE ARCHITECT CANNOT ACCEPT RESPONSIBILITY FOR THE ACCURACY OF THIS SURVEY INFORMATION.
 ALL DIMENSIONS ARE SHOWN IN METRIC. DO NOT SCALE FROM THIS DRAWING.
 THIS DRAWING REMAINS THE COPYRIGHT OF KARAKUSEVIC CARSON ARCHITECTS AND MAY NOT BE USED WITHOUT THEIR EXPRESSED WRITTEN CONSENT.
THESE DRAWINGS ARE NOT FOR CONSTRUCTION

NOTES
 FOR LANDSCAPE DETAILS REFER TO DRAWINGS BY PFS.
 FOR PARKING AND LOADING OPERATION REFER TO DRAWINGS BY BA GROUP.

- Phases 4&5 Property Line
- City of Toronto Owned Lands Right of Way
- Ancillary

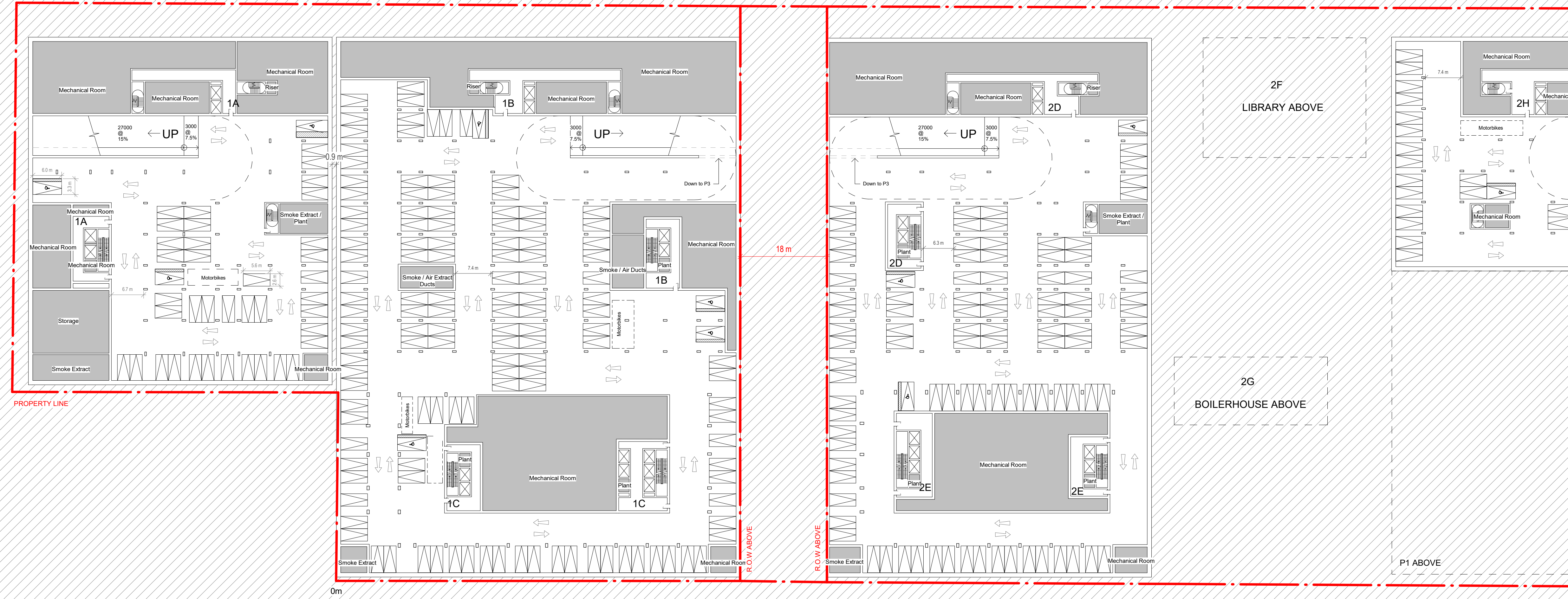

P03	S4	P2 - Issued for ZBA	11/29/22
P02	S3	P2 - Draft for Client Review	11/15/22
P01	S4	P1 - Issued for ZBA	04/14/22
P00	S3	P1 - Draft for Client Review	04/01/22

Rev. Status Reason for Issue Date

ARCHITECT OF RECORD
E.R.A. Architects Inc.
 625 Church St
 Suite 600
 Toronto
 Ontario, M4Y 2G1
 info@eraarch.ca | 416 963 4497



DESIGN
Karakusevic Carson Architects
 Studio 501
 37 Cremer St
 Hackney
 London E2 8HD
 mail@karakusevic-carson.com | +44(0)207 566 6300

PROJECT
Regent Park Phases 4 & 5

TITLE
Level P2 Plan - West

DRAWING NUMBER	REVISION	
577 - KCA-WE-P2-DR-A - 1002	P03	
STATUS	STAGE	
S4 - Suitable for stage approval	P2	
REVISION DATE	DRAWN BY	SCALE
11/29/22	H/AJAN	1 : 500 @ ARCH D
FIRST ISSUED	CHECKED BY	KCA PROJECT NUMBER
04/01/22	PK/RM	577

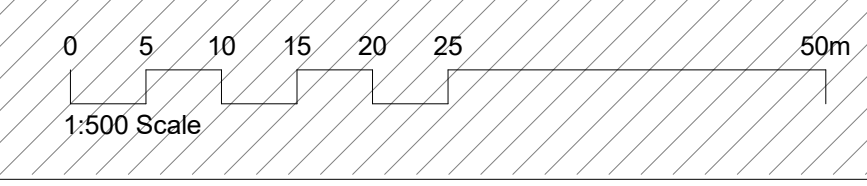

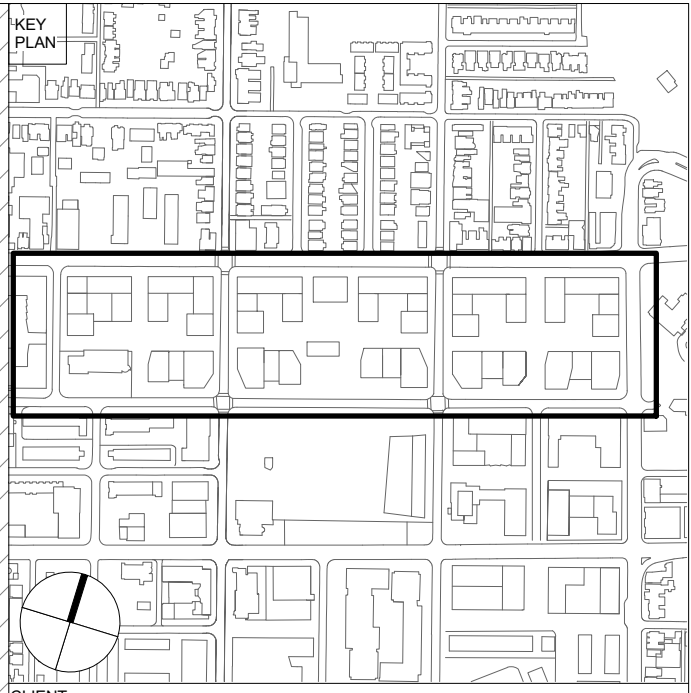

CLIENT
Toronto Community Housing Corporation (TCHC) and 2747199 Ontario Limited (Deltera Inc.)

THIS DRAWING IS BASED ON DIMENSIONAL SURVEY INFORMATION PROVIDED BY OTHERS AND REPRESENTS THE ARCHITECT'S BEST CURRENT UNDERSTANDING OF EXISTING CONDITIONS. THE ARCHITECT CANNOT ACCEPT RESPONSIBILITY FOR THE ACCURACY OF THIS SURVEY INFORMATION.
 ALL DIMENSIONS ARE SHOWN IN METRIC. DO NOT SCALE FROM THIS DRAWING.
 THIS DRAWING REMAINS THE COPYRIGHT OF KARAKUSEVIC CARSON ARCHITECTS AND MAY NOT BE USED WITHOUT THEIR EXPRESSED WRITTEN CONSENT.
THESE DRAWINGS ARE NOT FOR CONSTRUCTION

NOTES
 FOR LANDSCAPE DETAILS REFER TO DRAWINGS BY PFS.
 FOR PARKING AND LOADING OPERATION REFER TO DRAWINGS BY BA GROUP.

- Phases 4&5 Property Line
- City of Toronto Owned Lands Right of Way
- Ancillary
- Civic

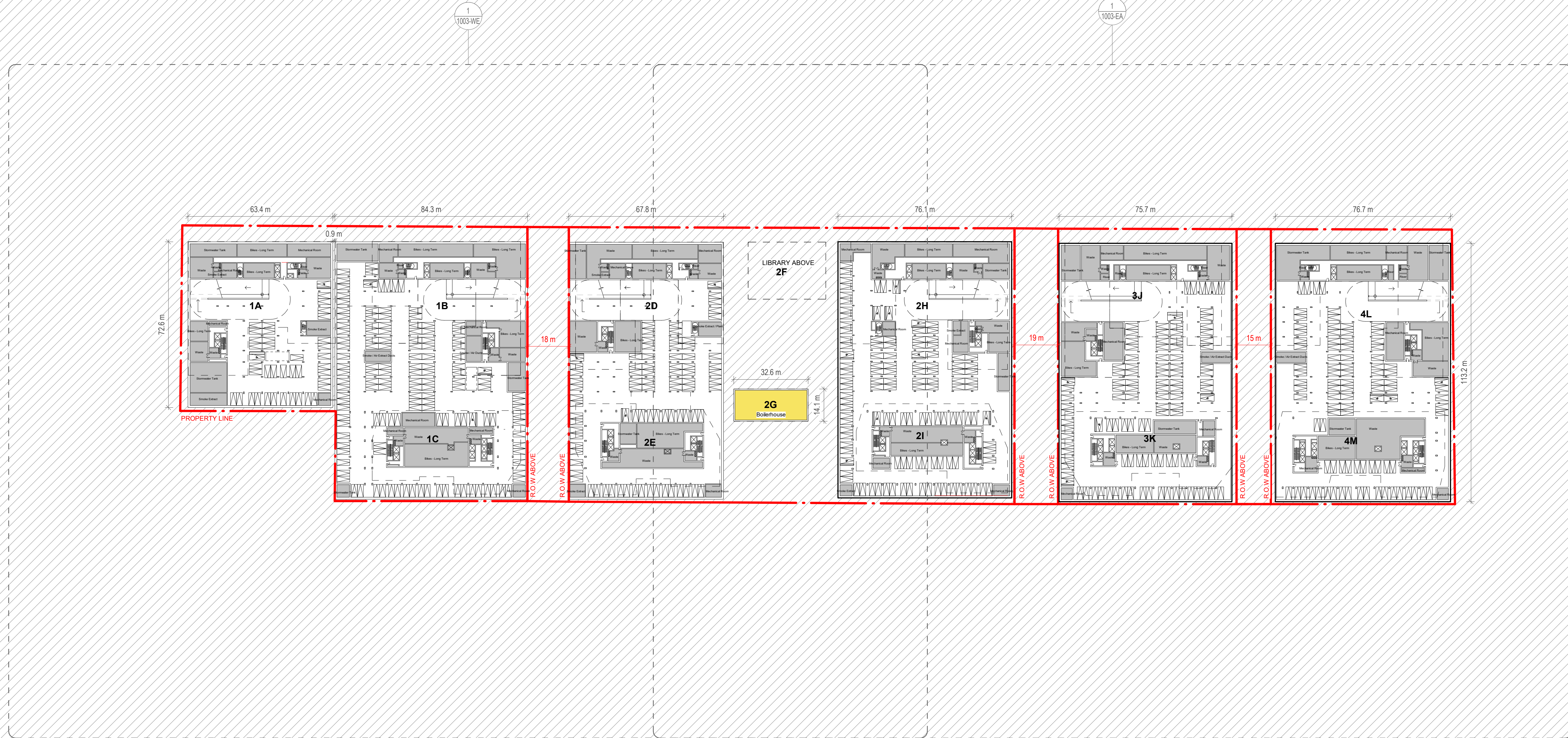

Rev.	Status	Reason for Issue	Date
P03	S4	P2 - Issued for ZBA	11/29/22
P02	S3	P2 - Draft for Client Review	11/15/22
P01	S4	P1 - Issued for ZBA	04/14/22
P00	S3	P1 - Draft for Client Review	04/01/22

ARCHITECT OF RECORD

E.R.A. Architects Inc.
 625 Church St
 Suite 600
 Toronto
 Ontario, M4Y 2G1
 info@eraarch.ca | 416 963 4497



DESIGN

Karakusevic Carson Architects
 Studio 501
 37 Cremer St
 Hackney
 London E2 8HD
 mail@karakusevic-carson.com | +44(0)207 566 6300

PROJECT

Regent Park Phases 4 & 5

TITLE

Level P1 Plan

DRAWING NUMBER

577 - KCA-XX-P1-DR-A - 1003 P03

STATUS

S4 - Suitable for stage approval P2

REVISION DATE

11/29/22

FIRST ISSUED

04/01/22

DRAWN BY

HA/JAN

CHECKED BY

PK/RM

KCA PROJECT NUMBER

577

SCALE

1 : 1000 @ ARCH D

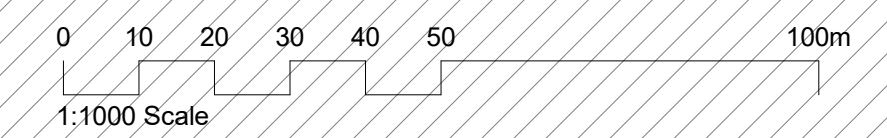

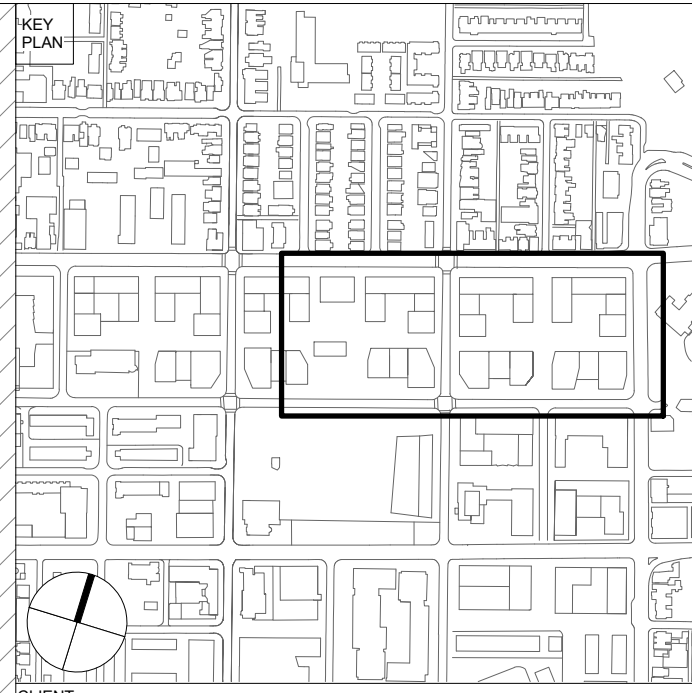

CLIENT
Toronto Community Housing Corporation (TCHC) and 2747199 Ontario Limited (Deltera Inc.)

THIS DRAWING IS BASED ON DIMENSIONAL SURVEY INFORMATION PROVIDED BY OTHERS AND REPRESENTS THE ARCHITECT'S BEST CURRENT UNDERSTANDING OF EXISTING CONDITIONS. THE ARCHITECT CANNOT ACCEPT RESPONSIBILITY FOR THE ACCURACY OF THIS SURVEY INFORMATION.
 ALL DIMENSIONS ARE SHOWN IN METRIC. DO NOT SCALE FROM THIS DRAWING.
 THIS DRAWING REMAINS THE COPYRIGHT OF KARAKUSEVIC CARSON ARCHITECTS AND MAY NOT BE USED WITHOUT THEIR EXPRESSED WRITTEN CONSENT.
THESE DRAWINGS ARE NOT FOR CONSTRUCTION

NOTES
 FOR LANDSCAPE DETAILS REFER TO DRAWINGS BY PFS.
 FOR PARKING AND LOADING OPERATION REFER TO DRAWINGS BY BA GROUP.

- Phases 4&5 Property Line
- City of Toronto Owned Lands Right of Way
- Ancillary
- Civic

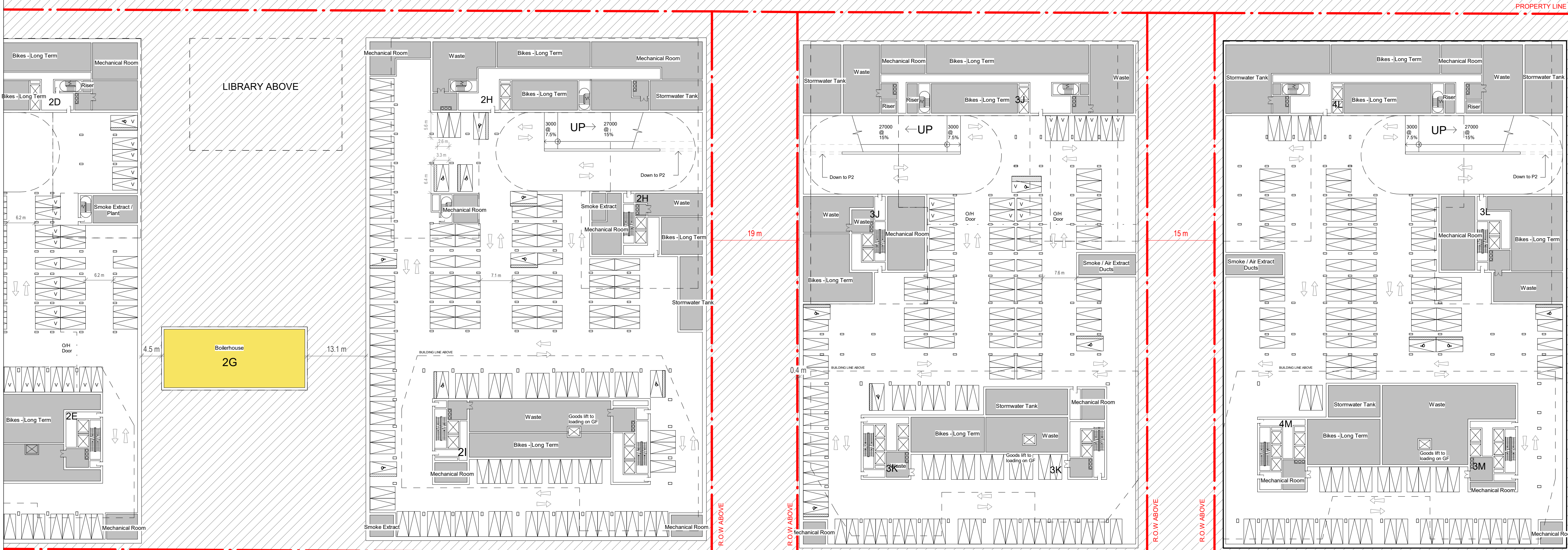

P03	S4	P2 - Issued for ZBA	11/29/22
P02	S3	P2 - Draft for Client Review	11/15/22
P01	S4	P1 - Issued for ZBA	04/14/22
P00	S3	P1 - Draft for Client Review	04/01/22

Rev: Status Reason for Issue Date

ARCHITECT OF RECORD
E.R.A. Architects Inc.
 625 Church St
 Suite 600
 Toronto
 Ontario, M4Y 2G1
 info@eraarch.ca | 416 963 4497



DESIGN
Karakusevic Carson Architects
 Studio 501
 37 Cremer St
 Hackney
 London E2 8HD
 mail@karakusevic-carson.com | +44(0)207 566 6300

PROJECT
Regent Park Phases 4 & 5

TITLE
Level P1 Plan - East

DRAWING NUMBER	REVISION	
577 - KCA-EA-P1-DR-A - 1003	P03	
STATUS	STAGE	
S4 - Suitable for stage approval	P2	
REVISION DATE	DRAWN BY	SCALE
11/29/22	H/AJAN	1 : 500 @ ARCH D
FIRST ISSUED	CHECKED BY	KCA PROJECT NUMBER
04/01/22	PK/RM	577

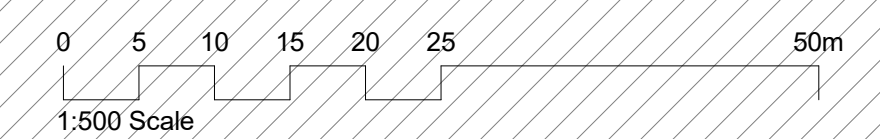

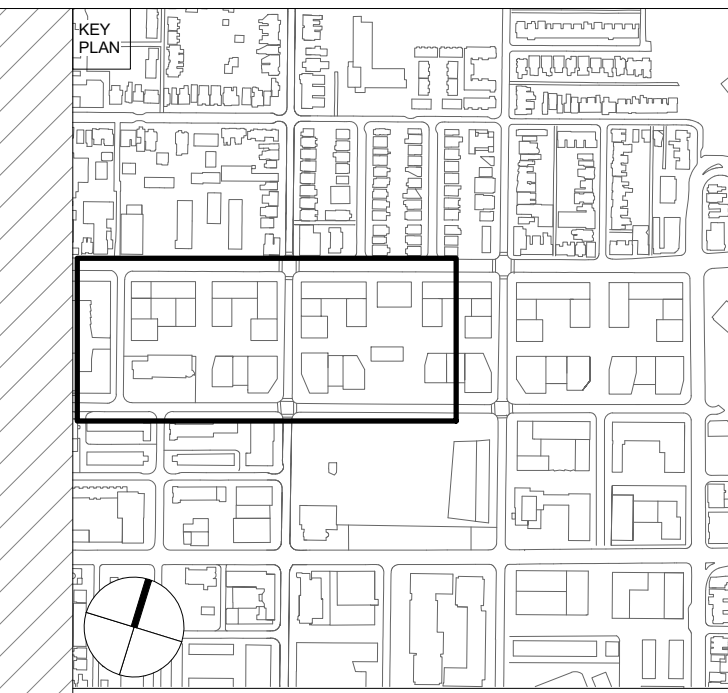

CLIENT
Toronto Community Housing Corporation (TCHC) and 2747199 Ontario Limited (Deltra Inc.)

THIS DRAWING IS BASED ON DIMENSIONAL SURVEY INFORMATION PROVIDED BY OTHERS AND REPRESENTS THE ARCHITECT'S BEST CURRENT UNDERSTANDING OF EXISTING CONDITIONS. THE ARCHITECT CANNOT ACCEPT RESPONSIBILITY FOR THE ACCURACY OF THIS SURVEY INFORMATION.
 ALL DIMENSIONS ARE SHOWN IN METRIC. DO NOT SCALE FROM THIS DRAWING.
 THIS DRAWING REMAINS THE COPYRIGHT OF KARAKUSEVIC CARSON ARCHITECTS AND MAY NOT BE USED WITHOUT THEIR EXPRESSED WRITTEN CONSENT.
THESE DRAWINGS ARE NOT FOR CONSTRUCTION

NOTES
 FOR LANDSCAPE DETAILS REFER TO DRAWINGS BY PFS.
 FOR PARKING AND LOADING OPERATION REFER TO DRAWINGS BY BA GROUP.

- Phases 4&5 Property Line
- City of Toronto Owned Lands Right of Way
- Ancillary
- Civic

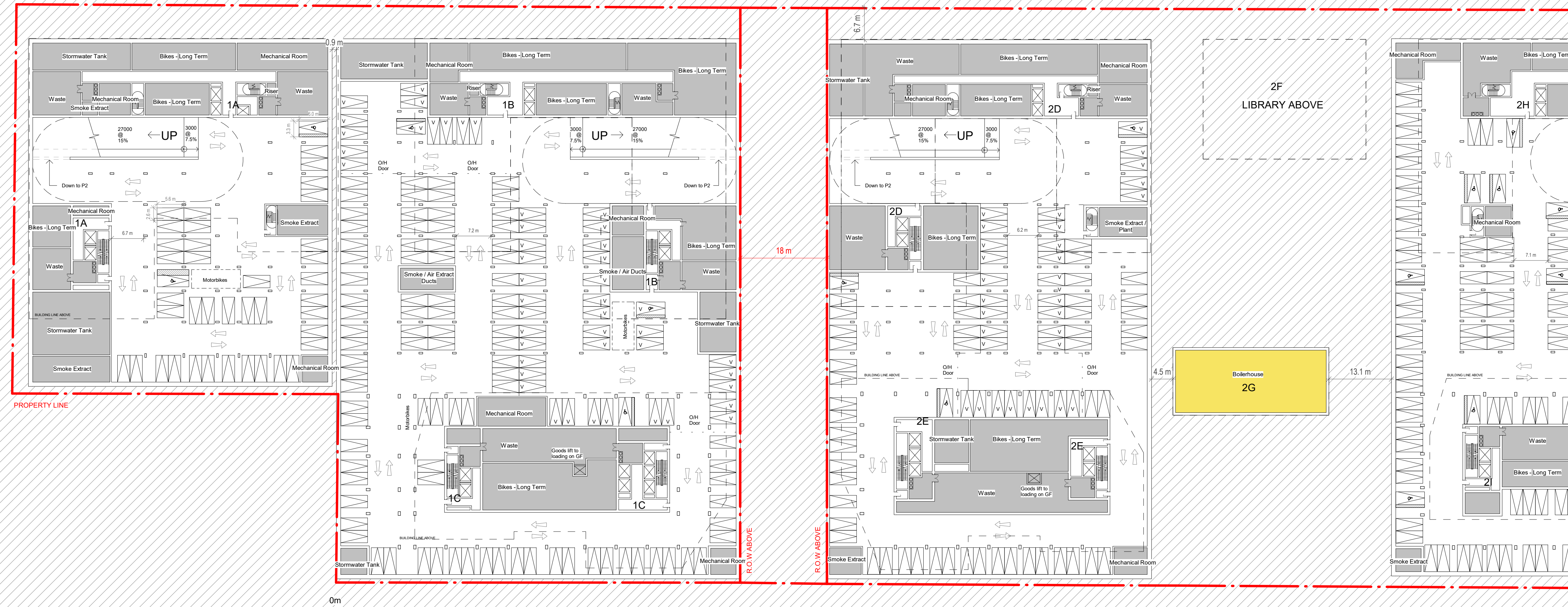

P03	S4	P2	- Issued for ZBA	11/29/22
P02	S3	P2	- Draft for Client Review	11/15/22
P01	S4	P1	- Issued for ZBA	04/14/22
P00	S3	P1	- Draft for Client Review	04/01/22

ARCHITECT OF RECORD
E.R.A. Architects Inc.
 625 Church St
 Suite 600
 Toronto
 Ontario, M4Y 2G1
 info@eraarch.ca | 416 963 4497



DESIGN
Karakusevic Carson Architects
 Studio 501
 37 Cremer St
 Hackney
 London E2 8HD
 mail@karakusevic-carson.com | +44(0)207 566 6300

PROJECT
Regent Park Phases 4 & 5

TITLE
Level P1 Plan - West

DRAWING NUMBER	577 - KCA-WE-P1-DR-A - 1003	REVISION	P03
STATUS	S4 - Suitable for stage approval	STAGE	P2
REVISION DATE	11/29/22	DRAWN BY	H/AJAN
FIRST ISSUED	04/01/22	CHECKED BY	PK/RM
		KCA PROJECT NUMBER	577

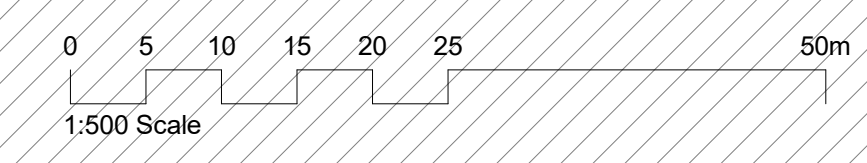

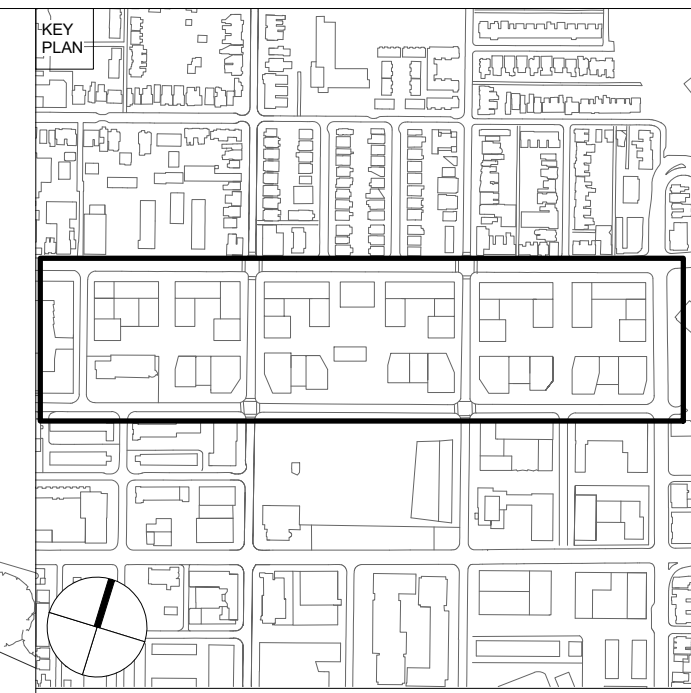
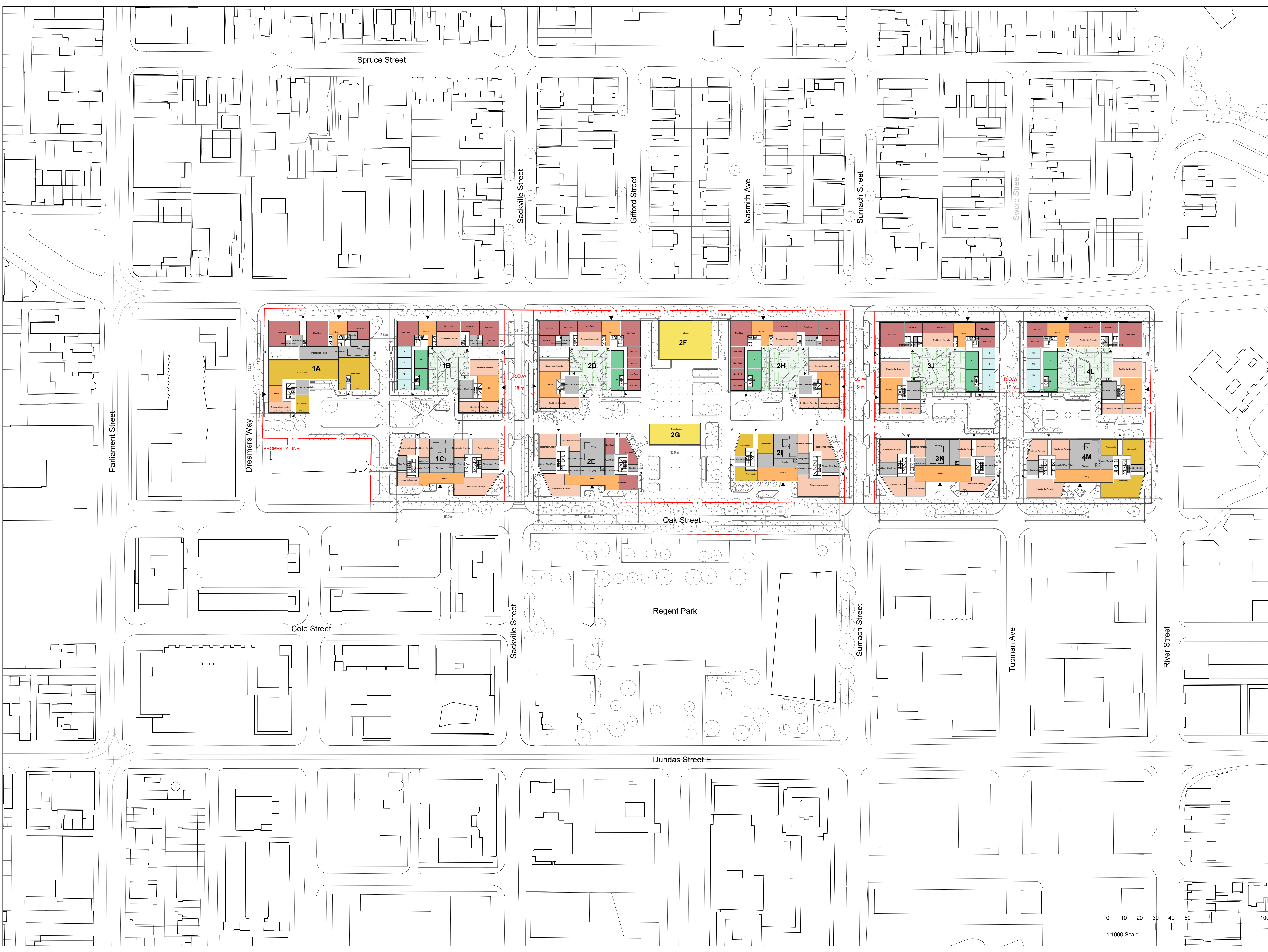

CLIENT
Toronto Community Housing Corporation (TCHC) and 2747199 Ontario Limited (Deltra Inc.)

THIS DRAWING IS BASED ON DIMENSIONAL SURVEY INFORMATION PROVIDED BY OTHERS AND REPRESENTS THE ARCHITECTS' BEST CURRENT UNDERSTANDING OF EXISTING CONDITIONS. THE ARCHITECT CANNOT ACCEPT RESPONSIBILITY FOR THE ACCURACY OF THIS SURVEY INFORMATION.
 ALL DIMENSIONS ARE SHOWN IN METRIC. DO NOT SCALE FROM THIS DRAWING.
 THIS DRAWING REMAINS THE COPYRIGHT OF KARAKUSEVIC CARSON ARCHITECTS AND MAY NOT BE USED WITHOUT THEIR EXPRESSED WRITTEN CONSENT.
THESE DRAWINGS ARE NOT FOR CONSTRUCTION

NOTES
 FOR LANDSCAPE DETAILS REFER TO DRAWINGS BY PFS.
 FOR PARKING AND LOADING OPERATION REFER TO DRAWINGS BY BA GROUP.

Phases 4&5 Property Line
 --- City of Toronto Owned Lands Right of Way

- 1B
- 1B+
- 2B
- 2B+
- 3B
- 3B+
- 4B
- 5B
- Amenity
- Ancillary
- Civic
- Community
- Lobby
- Retail
- Residential Outdoor Amenity

Plot	Building	Level	Name	Estimated No. Bikes
1	A	Level 0	Bikes - Non Residential	56
1	B	Level 0	Bikes - Short Term	71
2	D	Level 0	Bikes - Short Term	70
2	E	Level 0	Bikes - Short Term	58
2	F	Level 0	Bikes - Non Residential	20
2	H	Level 0	Bikes - Short Term	70
2	I	Level 0	Bikes - Non Residential	19
2	J	Level 0	Bikes - Short Term	58
3	J	Level 0	Bikes - Short Term	71
3	K	Level 0	Bikes - Long Term	53
3	K	Level 0	Bikes - Short Term	56
3	L	Level 0	Bikes - Short Term	71
3	M	Level 0	Bikes - Non Residential	24
3	M	Level 0	Bikes - Long Term	45
Grand total				759

P03 S4 P2	- Issued for ZBA	11/29/22
P02 S3 P2	- Draft for Client Review	11/15/22
P01 S4 P1	- Issued for ZBA	04/14/22
P00 S3 P1	- Draft for Client Review	04/01/22

ARCHITECT OF RECORD
E.R.A. Architects Inc.
 625 Church St
 Suite 600
 Toronto
 Ontario, M4Y 2G1
 info@eraarch.ca | 416 963 4497



DESIGN
Karakusevic Carson Architects
 Studio 501
 37 Cremer St
 Hackney
 London E2 8HD
 mail@karakusevic-carson.com | +44(0)207 566 6300

PROJECT
Regent Park Phases 4 & 5

TITLE
Ground Floor Plan

DRAWING NUMBER	577 - KCA - XX - 01 - DR - A - 1004	REVISION	P03
STATUS	S4 - Suitable for stage approval	SCALE	1 : 1000 @ ARCH D
REVISION DATE	11/29/22	DRAWN BY	H/AJAN
FIRST ISSUED	04/01/22	CHECKED BY	PK/RM
		KCA PROJECT NUMBER	577

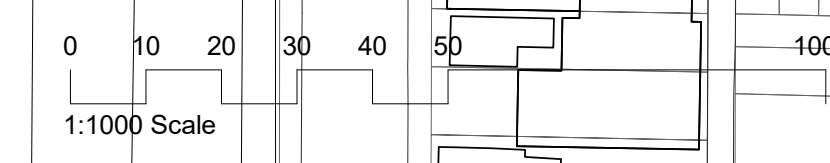

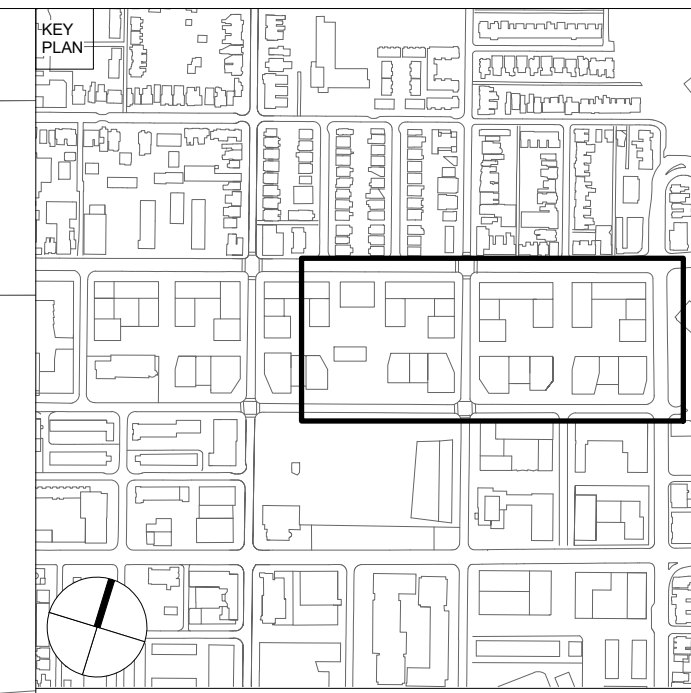
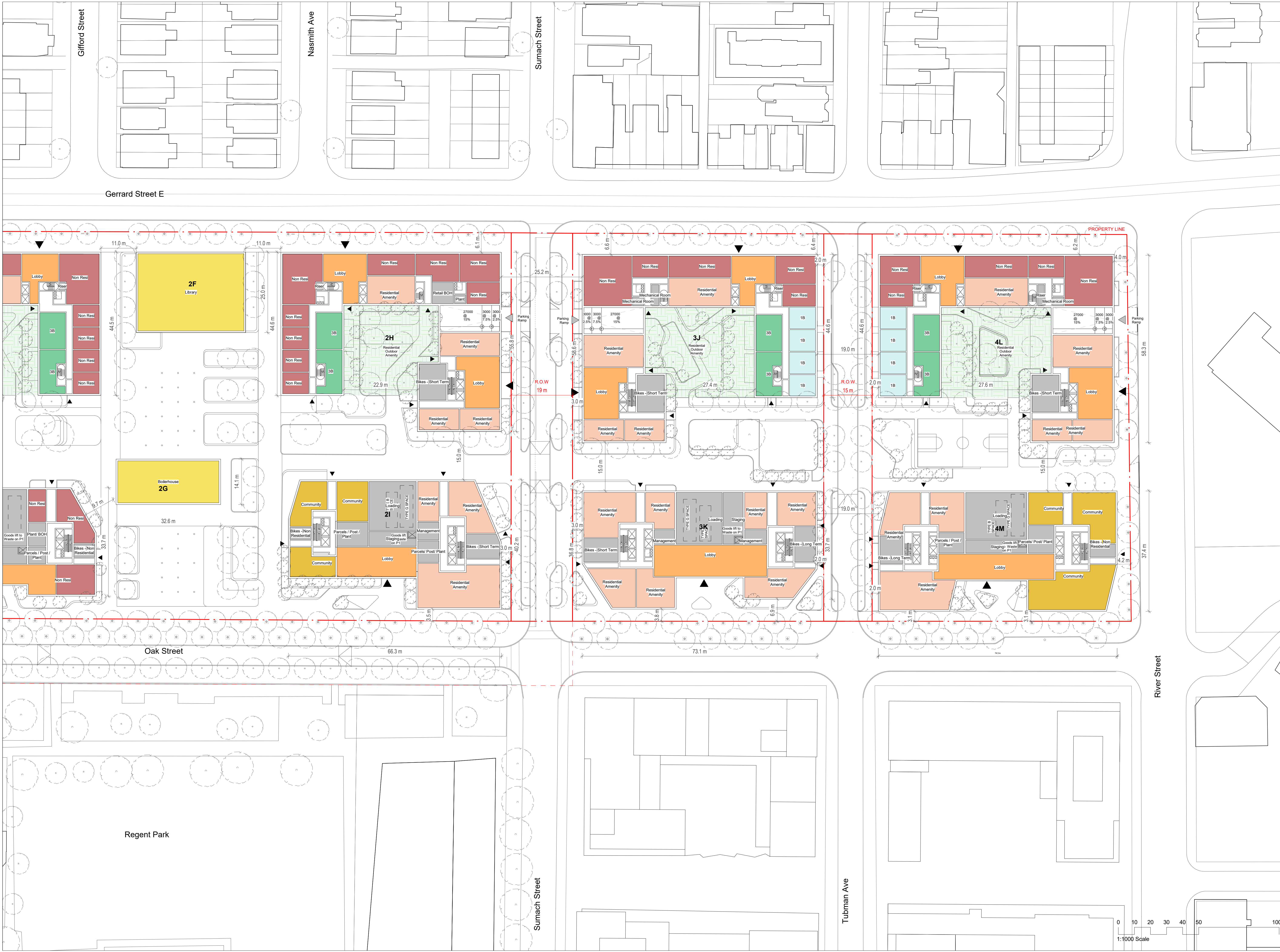

CLIENT
Toronto Community Housing Corporation (TCHC) and 2747199 Ontario Limited (Deltra Inc.)

THIS DRAWING IS BASED ON DIMENSIONAL SURVEY INFORMATION PROVIDED BY OTHERS AND REPRESENTS THE ARCHITECT'S BEST CURRENT UNDERSTANDING OF EXISTING CONDITIONS. THE ARCHITECT CANNOT ACCEPT RESPONSIBILITY FOR THE ACCURACY OF THIS SURVEY INFORMATION.
 ALL DIMENSIONS ARE SHOWN IN METRIC. DO NOT SCALE FROM THIS DRAWING.
 THIS DRAWING REMAINS THE COPYRIGHT OF KARAKUSEVIC CARSON ARCHITECTS AND MAY NOT BE USED WITHOUT THEIR EXPRESSED WRITTEN CONSENT.
THESE DRAWINGS ARE NOT FOR CONSTRUCTION

NOTES
 FOR LANDSCAPE DETAILS REFER TO DRAWINGS BY PFS
 FOR PARKING AND LOADING OPERATION REFER TO DRAWINGS BY BA GROUP.

Phases 4&5 Property Line
 City of Toronto Owned Lands Right of Way

- 1B
- 1B+
- 2B
- 2B+
- 3B
- 3B+
- 4B
- 5B
- Amenity
- Ancillary
- Civic
- Community
- Lobby
- Retail
- Residential Outdoor Amenity

P03 S4 P2 - Issued for ZBA	11/29/22
P02 S3 P2 - Draft for Client Review	11/15/22
P01 S4 P1 - Issued for ZBA	04/14/22
P00 S3 P1 - Draft for Client Review	04/01/22

ARCHITECT OF RECORD
E.R.A. Architects Inc.
 625 Church St
 Suite 600
 Toronto
 Ontario, M4Y 2G1
 info@eraarch.ca | 416 963 4497



DESIGN
Karakusevic Carson Architects
 Studio 501
 37 Cremer St
 Hackney
 London E2 8HD
 mail@karakusevic-carson.com | +44(0)207 566 6300

PROJECT
Regent Park Phases 4 & 5

TITLE
Ground Floor Plan - East

DRAWING NUMBER 577 - KCA - EA - 01 - DR - A - 1004	REVISION P03
STATUS S4 - Suitable for stage approval	STAGE P2
REVISION DATE 11/29/22	DRAWN BY H/AJAN
FIRST ISSUED 04/01/22	CHECKED BY PK/RM
	KCA PROJECT NUMBER 577

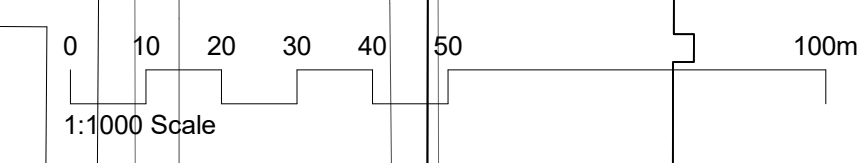

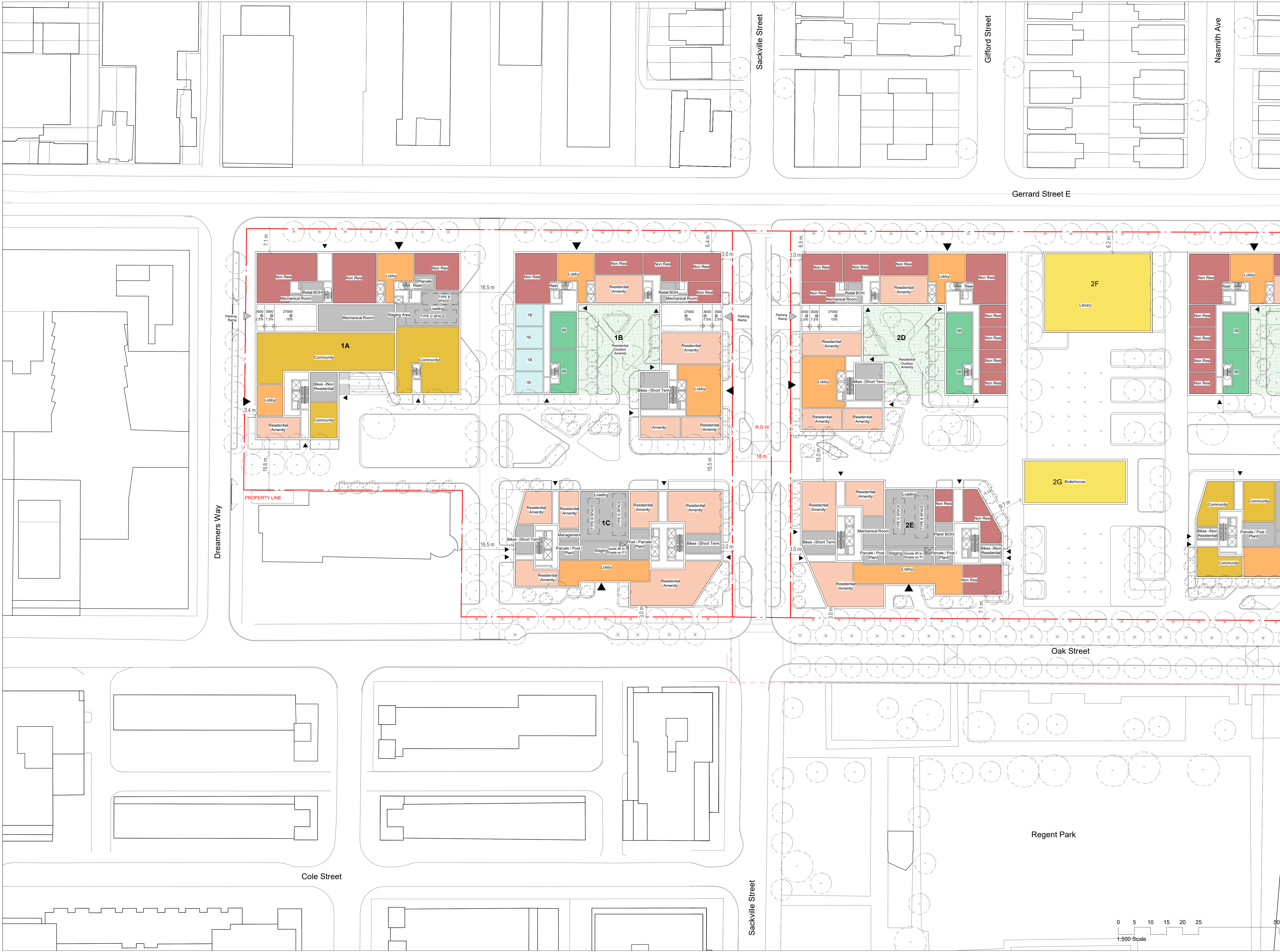

KEY PLAN

CLIENT
Toronto Community Housing Corporation (TCHC) and 2747199 Ontario Limited (Deltra Inc.)

THIS DRAWING IS BASED ON DIMENSIONAL SURVEY INFORMATION PROVIDED BY OTHERS AND REPRESENTS THE ARCHITECT'S BEST CURRENT UNDERSTANDING OF EXISTING CONDITIONS. THE ARCHITECT CANNOT ACCEPT RESPONSIBILITY FOR THE ACCURACY OF THIS SURVEY INFORMATION.

ALL DIMENSIONS ARE SHOWN IN METRIC. DO NOT SCALE FROM THIS DRAWING.

THIS DRAWING REMAINS THE COPYRIGHT OF KARAKUSEVIC CARSON ARCHITECTS AND MAY NOT BE USED WITHOUT THEIR EXPRESSED WRITTEN CONSENT.

THESE DRAWINGS ARE NOT FOR CONSTRUCTION

NOTES

FOR LANDSCAPE DETAILS REFER TO DRAWINGS BY PFS

FOR PARKING AND LOADING OPERATION REFER TO DRAWINGS BY BA GROUP.

Phases 4&5 Property Line

City of Toronto Owned Lands Right of Way

- 1B
- 1B+
- 2B
- 2B+
- 3B
- 3B+
- 4B
- 5B
- Amenity
- Ancillary
- Civic
- Community
- Lobby
- Retail
- Residential Outdoor Amenity

P03	S4	P2 - Issued for ZBA	11/29/22
P02	S3	P2 - Draft for Client Review	11/15/22
P01	S4	P1 - Issued for ZBA	04/14/22
P00	S3	P1 - Draft for Client Review	04/01/22

ARCHITECT OF RECORD

E.R.A. Architects Inc.
 625 Church St
 Suite 600
 Toronto
 Ontario, M4Y 2G1
 info@eraarch.ca | 416 963 4497



DESIGN

Karakusevic Carson Architects
 Studio 501
 37 Cremer St
 Hackney
 London E2 8HD
 mail@karakusevic-carson.com | +44(0)207 566 6300

PROJECT

Regent Park Phases 4 & 5

TITLE

Ground Floor Plan - West

DRAWING NUMBER	577 - KCA-WE-01-DR-A - 1004	REVISION	P03
STATUS	S4 - Suitable for stage approval	STAGE	P2
REVISION DATE	11/29/22	DRAWN BY	H/A/JAN
FIRST ISSUED	04/01/22	CHECKED BY	PK/RM
		KCA PROJECT NUMBER	577

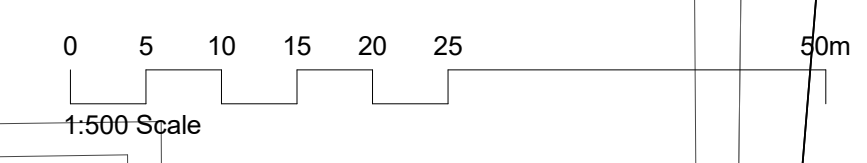

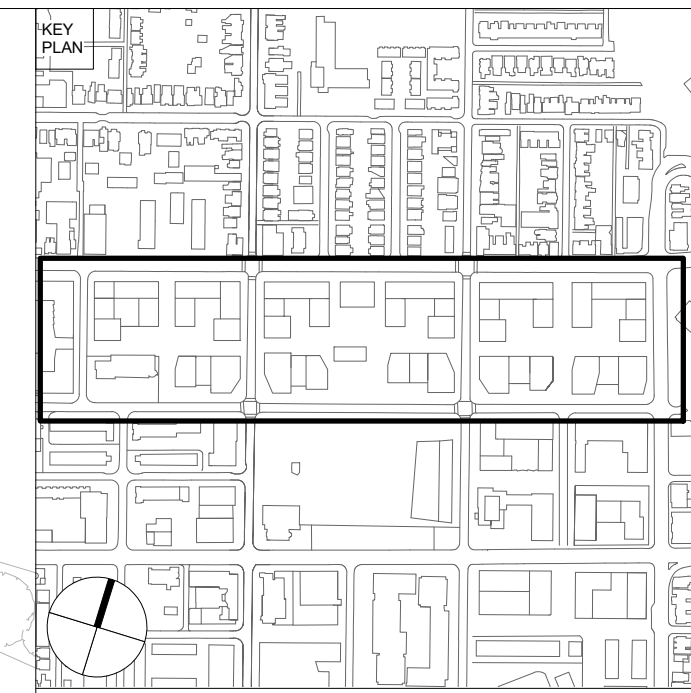
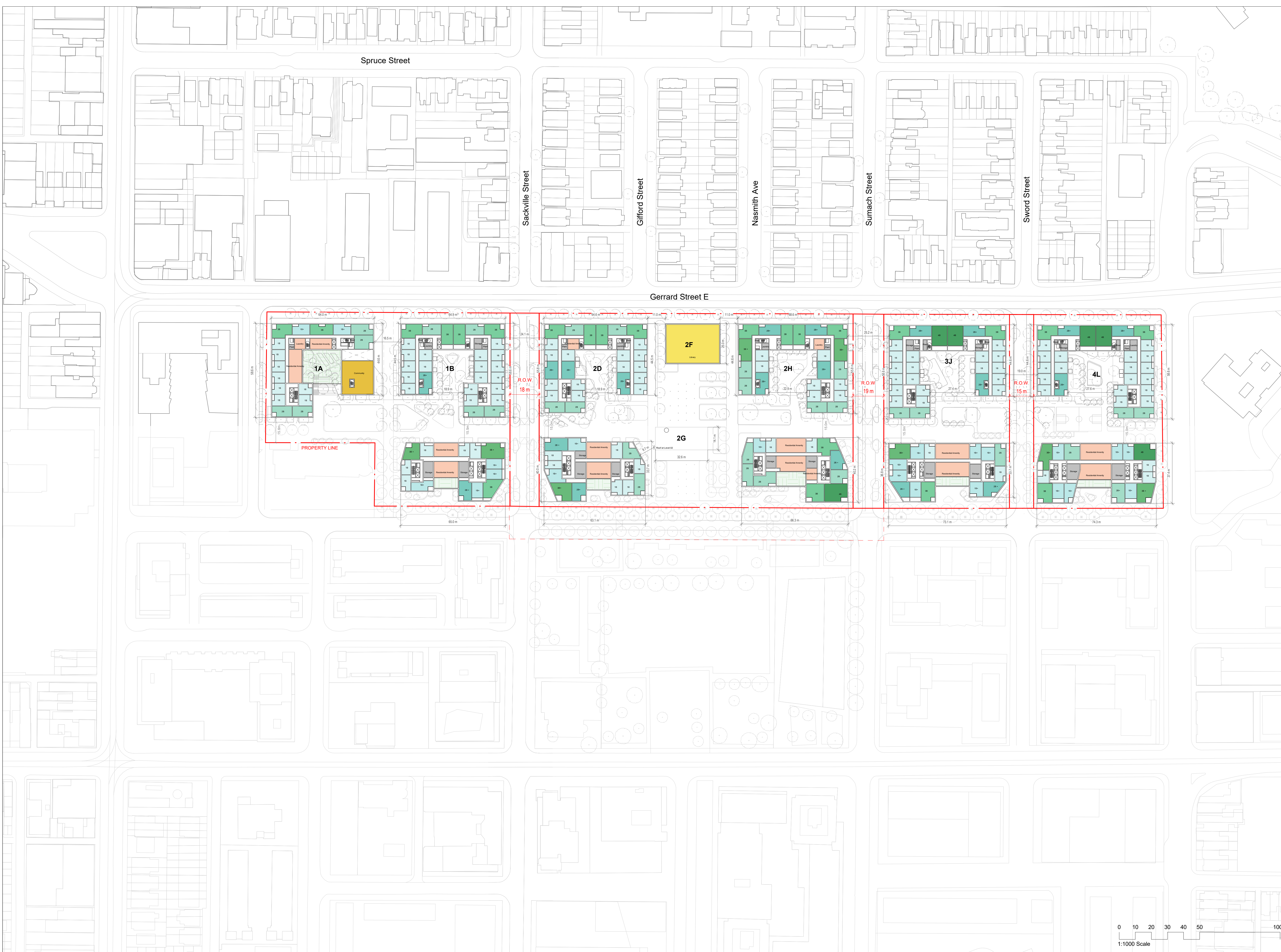

CLIENT
Toronto Community Housing Corporation (TCHC) and 2747199 Ontario Limited (Deltra Inc.)

THIS DRAWING IS BASED ON DIMENSIONAL SURVEY INFORMATION PROVIDED BY OTHERS AND REPRESENTS THE ARCHITECT'S BEST CURRENT UNDERSTANDING OF EXISTING CONDITIONS. THE ARCHITECT CANNOT ACCEPT RESPONSIBILITY FOR THE ACCURACY OF THIS SURVEY INFORMATION.
 ALL DIMENSIONS ARE SHOWN IN METRIC. DO NOT SCALE FROM THIS DRAWING.
 THIS DRAWING REMAINS THE COPYRIGHT OF KARAKUSEVIC CARSON ARCHITECTS AND MAY NOT BE USED WITHOUT THEIR EXPRESSED WRITTEN CONSENT.
THESE DRAWINGS ARE NOT FOR CONSTRUCTION

- NOTES
- Phases 4&5 Property Line
 - City of Toronto Owned Lands Right of Way

- Bedrooms_KS Grouped**
- 1B
 - 1B+
 - 2B
 - 2B+
 - 3B
 - 3B+
 - 4B
 - Amenity
 - Ancillary
 - Civic
 - Community
 - Residential Outdoor Amenity

P03 S4 P2 - Issued for ZBA	11/29/22
P02 S3 P2 - Draft for Client Review	11/15/22
P01 S4 P1 - Issued for ZBA	04/14/22
P00 S3 P1 - Draft for Client Review	04/01/22

ARCHITECT OF RECORD
E.R.A. Architects Inc.
 625 Church St
 Suite 600
 Toronto
 Ontario, M4Y 2G1
 info@eraarch.ca | 416 963 4497



DESIGN
Karakusevic Carson Architects
 Studio 501
 37 Cremer St
 Hackney
 London E2 8HD
 mail@karakusevic-carson.com | +44(0)207 566 6300

PROJECT
Regent Park Phases 4 & 5

TITLE
Level 02 Plan

DRAWING NUMBER	577 - KCA-XX-02-DR-A - 1006	REVISION	P03
STATUS	S4 - Suitable for stage approval	STAGE	P2
REVISION DATE	11/29/22	DRAWN BY	H/A/J
FIRST ISSUED	04/01/22	CHECKED BY	PK/RM
		KCA PROJECT NUMBER	577

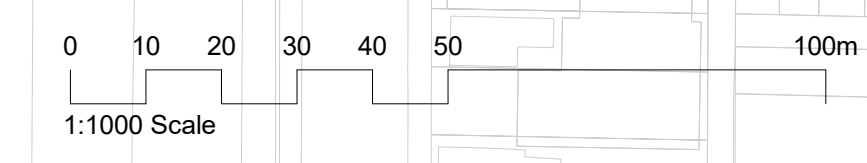

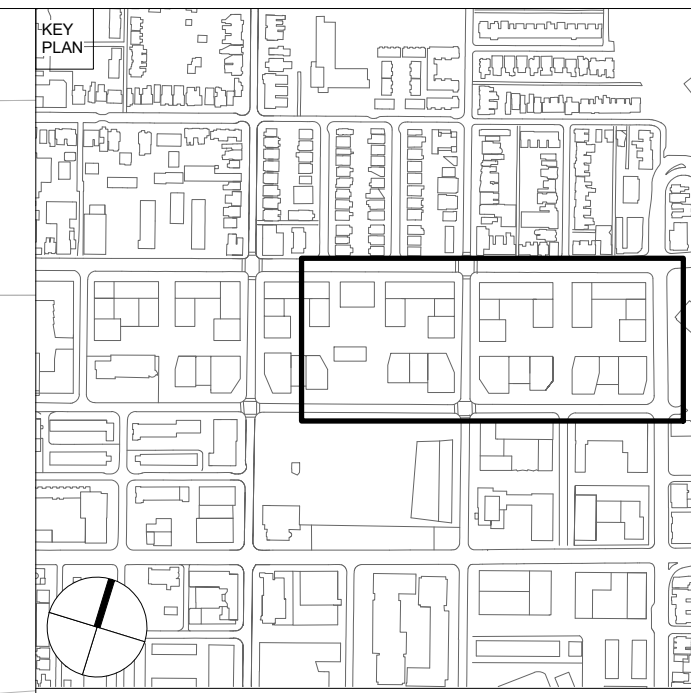

CLIENT
Toronto Community Housing Corporation (TCHC) and 2747199 Ontario Limited (Deltera Inc.)

THIS DRAWING IS BASED ON DIMENSIONAL SURVEY INFORMATION PROVIDED BY OTHERS AND REPRESENTS THE ARCHITECT'S BEST CURRENT UNDERSTANDING OF EXISTING CONDITIONS. THE ARCHITECT CANNOT ACCEPT RESPONSIBILITY FOR THE ACCURACY OF THIS SURVEY INFORMATION.
 ALL DIMENSIONS ARE SHOWN IN METRIC. DO NOT SCALE FROM THIS DRAWING.
 THIS DRAWING REMAINS THE COPYRIGHT OF KARAKUSEVIC CARSON ARCHITECTS AND MAY NOT BE USED WITHOUT THEIR EXPRESSED WRITTEN CONSENT.
 THESE DRAWINGS ARE NOT FOR CONSTRUCTION

NOTES

- Phases 4&5 Property Line
- City of Toronto Owned Lands Right of Way
- 1B
- 1B+
- 2B
- 2B+
- 3B
- 3B+
- 4B
- 5B
- Amenity
- Ancillary
- Civic
- Community
- Lobby
- Retail
- Residential Outdoor Amenity

P03	S4	P2 - Issued for ZBA	11/29/22
P02	S3	P2 - Draft for Client Review	11/15/22
P01	S4	P1 - Issued for ZBA	04/14/22
P00	S3	P1 - Draft for Client Review	04/01/22

Rev. Status Reason for Issue Date

ARCHITECT OF RECORD
E.R.A. Architects Inc.
 625 Church St
 Suite 600
 Toronto
 Ontario, M4Y 2G1
 info@eraarch.ca | 416 963 4497



DESIGN
Karakusevic Carson Architects
 Studio 501
 37 Cremer St
 Hackney
 London E2 8HD
 mail@karakusevic-carson.com | +44(0)207 566 6300

PROJECT
Regent Park Phases 4 & 5

TITLE
Level 02 Plan - East

DRAWING NUMBER	577 - KCA - EA - 02 - DR - A - 1006	REVISION	P03
STATUS	S4 - Suitable for stage approval	STAGE	P2
REVISION DATE	11/29/22	DRAWN BY	H/AJAN
FIRST ISSUED	04/01/22	CHECKED BY	PK/RM
		KCA PROJECT NUMBER	577

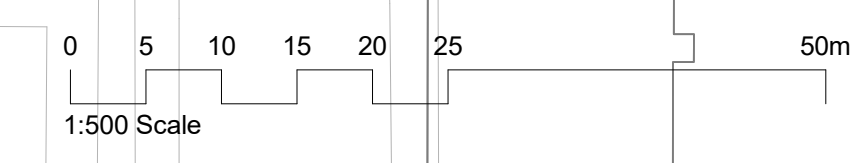

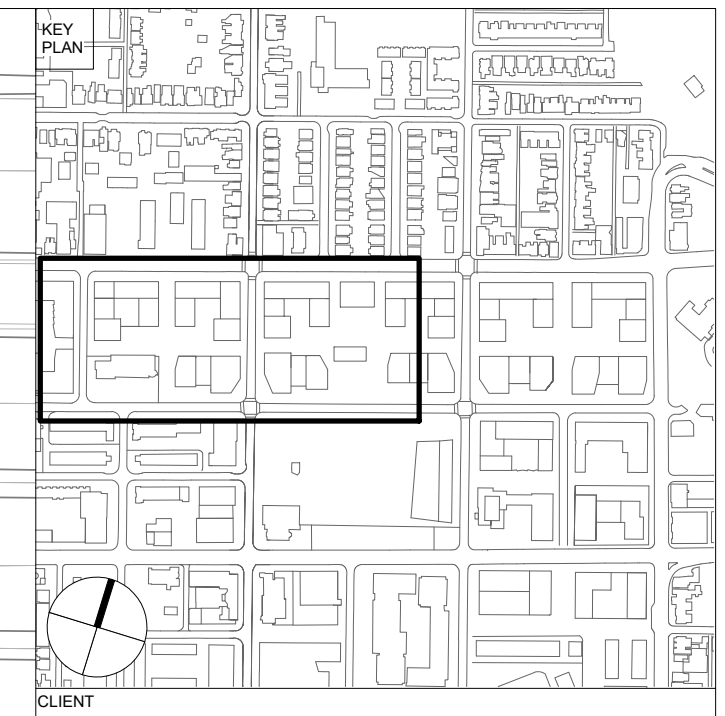
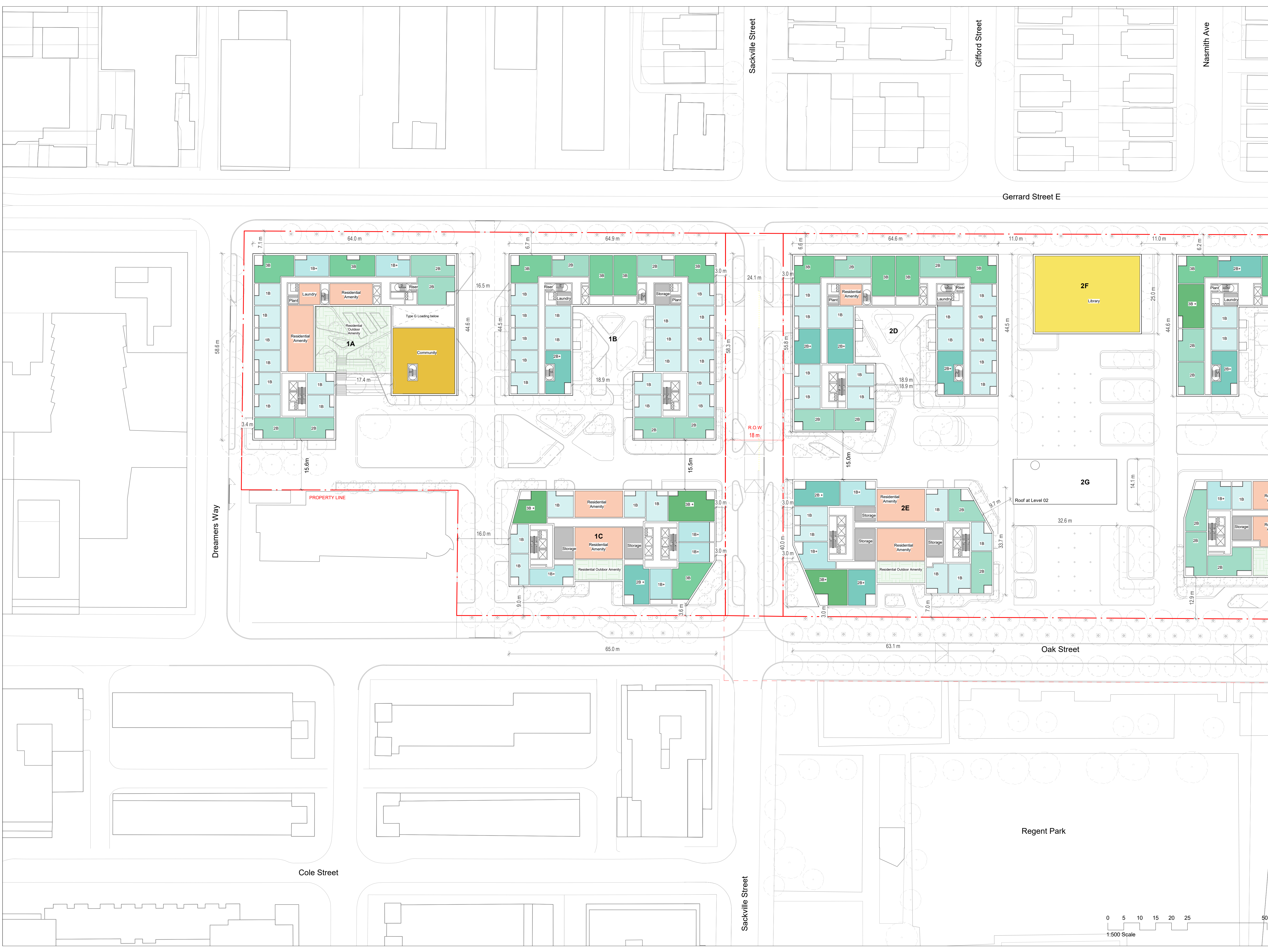

CLIENT
Toronto Community Housing Corporation (TCHC) and 2747199 Ontario Limited (Deltra Inc.)

THIS DRAWING IS BASED ON DIMENSIONAL SURVEY INFORMATION PROVIDED BY OTHERS AND REPRESENTS THE ARCHITECT'S BEST CURRENT UNDERSTANDING OF EXISTING CONDITIONS. THE ARCHITECT CANNOT ACCEPT RESPONSIBILITY FOR THE ACCURACY OF THIS SURVEY INFORMATION.
 ALL DIMENSIONS ARE SHOWN IN METRIC. DO NOT SCALE FROM THIS DRAWING.
 THIS DRAWING REMAINS THE COPYRIGHT OF KARAKUSEVIC CARSON ARCHITECTS AND MAY NOT BE USED WITHOUT THEIR EXPRESSED WRITTEN CONSENT.
 THESE DRAWINGS ARE NOT FOR CONSTRUCTION

- NOTES
- Phases 4&5 Property Line
 - City of Toronto Owned Lands Right of Way
 - 1B
 - 1B+
 - 2B
 - 2B+
 - 3B
 - 3B+
 - 4B
 - 5B
 - Amenity
 - Ancillary
 - Civic
 - Community
 - Lobby
 - Retail
 - Residential Outdoor Amenity

P03	S4	P2 - Issued for ZBA	11/29/22
P02	S3	P2 - Draft for Client Review	11/15/22
P01	S4	P1 - Issued for ZBA	04/14/22
P00	S3	P1 - Draft for Client Review	04/01/22

ARCHITECT OF RECORD
E.R.A. Architects Inc.
 625 Church St
 Suite 600
 Toronto
 Ontario, M4Y 2G1
 info@eraarch.ca | 416 963 4497



DESIGN
Karakusevic Carson Architects
 Studio 501
 37 Cremer St
 Hackney
 London E2 8HD
 mail@karakusevic-carson.com | +44(0)207 566 6300

PROJECT
Regent Park Phases 4 & 5

TITLE
Level 02 Plan - West

DRAWING NUMBER	577 - KCA-WE-02-DR-A - 1006	REVISION	P03
STATUS	S4 - Suitable for stage approval	STAGE	P2
REVISION DATE	11/29/22	DRAWN BY	H/A/J
FIRST ISSUED	04/01/22	CHECKED BY	PK/RM
		KCA PROJECT NUMBER	577

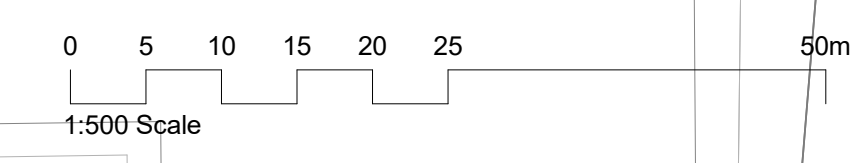

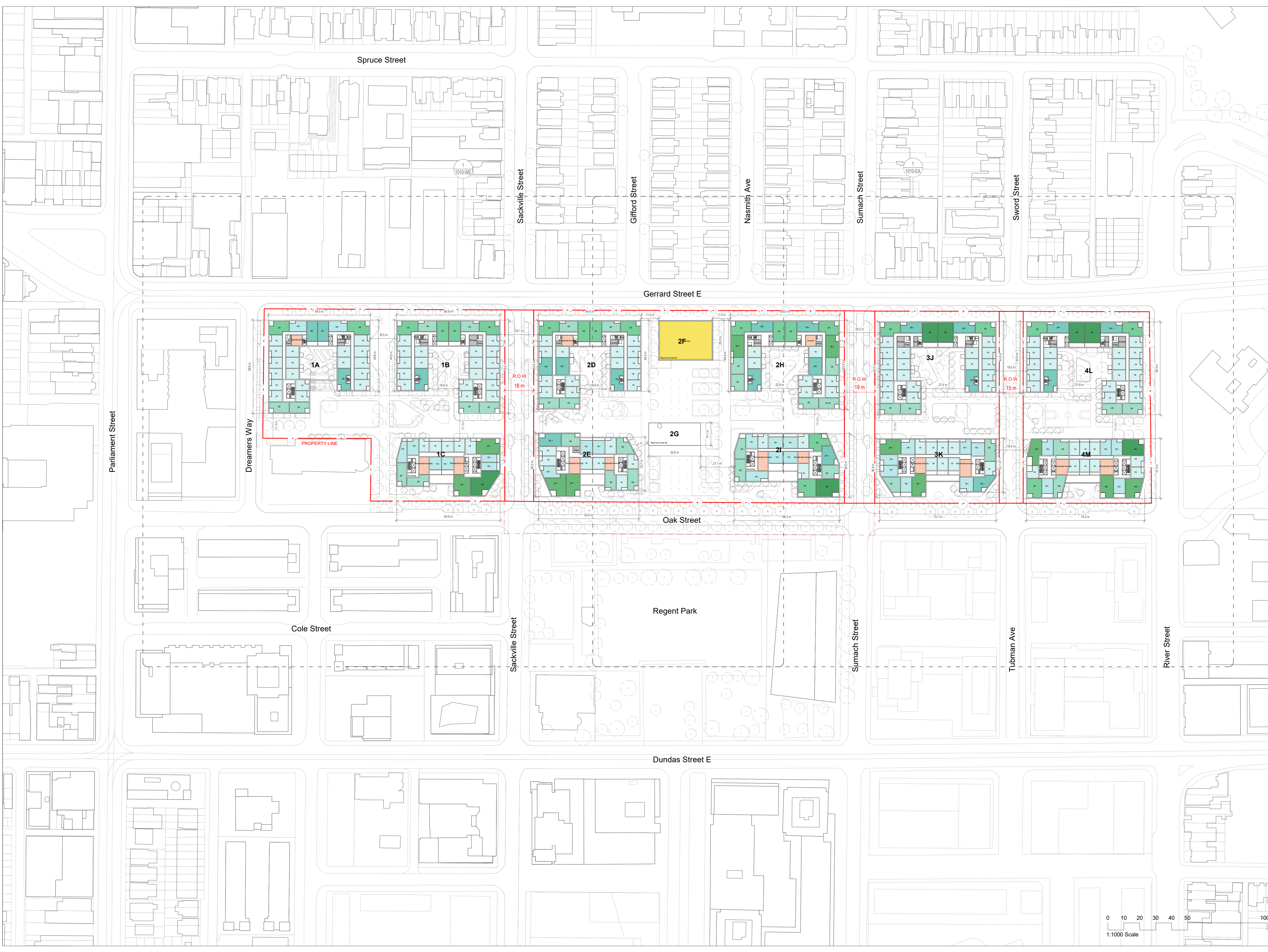

KEY PLAN

CLIENT
Toronto Community Housing Corporation (TCHC) and 2747199 Ontario Limited (Deltera Inc.)

THIS DRAWING IS BASED ON DIMENSIONAL SURVEY INFORMATION PROVIDED BY OTHERS AND REPRESENTS THE ARCHITECTS' BEST CURRENT UNDERSTANDING OF EXISTING CONDITIONS. THE ARCHITECTS CANNOT ACCEPT RESPONSIBILITY FOR THE ACCURACY OF THIS SURVEY INFORMATION.

ALL DIMENSIONS ARE SHOWN IN METRIC. DO NOT SCALE FROM THIS DRAWING.

THIS DRAWING REMAINS THE COPYRIGHT OF KARAKUSEVIC CARSON ARCHITECTS AND MAY NOT BE USED WITHOUT THEIR EXPRESSED WRITTEN CONSENT.

THESE DRAWINGS ARE NOT FOR CONSTRUCTION

- NOTES
- Phases 4&5 Property Line
 - City of Toronto Owned Lands Right of Way
- 1B
 - 1B+
 - 2B
 - 2B+
 - 3B
 - 3B+
 - 4B
 - 5B
 - Amenity
 - Ancillary
 - Civic
 - Community
 - Lobby
 - Retail

P03 S4 P2 - Issued for ZBA	11/29/22
P02 S3 P2 - Draft for Client Review	11/15/22
P01 S4 P1 - Issued for ZBA	04/14/22
P00 S3 P1 - Draft for Client Review	04/01/22

ARCHITECT OF RECORD

E.R.A. Architects Inc.
 625 Church St
 Suite 600
 Toronto
 Ontario, M4Y 2G1
 info@eraarch.ca | 416 963 4497



DESIGN

Karakusevic Carson Architects
 Studio 501
 37 Cremer St
 Hackney
 London E2 8HD
 mail@karakusevic-carson.com | +44(0)207 566 6300

PROJECT

Regent Park Phases 4 & 5

TITLE

Level 05 Plan

DRAWING NUMBER	577 - KCA - XX - 05 - DR - A - 1010	REVISION	P03
STATUS	S4 - Suitable for stage approval	STAGE	P2
REVISION DATE	11/29/22	DRAWN BY	H/A/JAN
FIRST ISSUED	04/01/22	CHECKED BY	PK/RM
		KCA PROJECT NUMBER	577

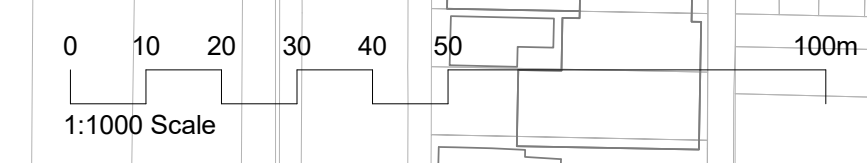

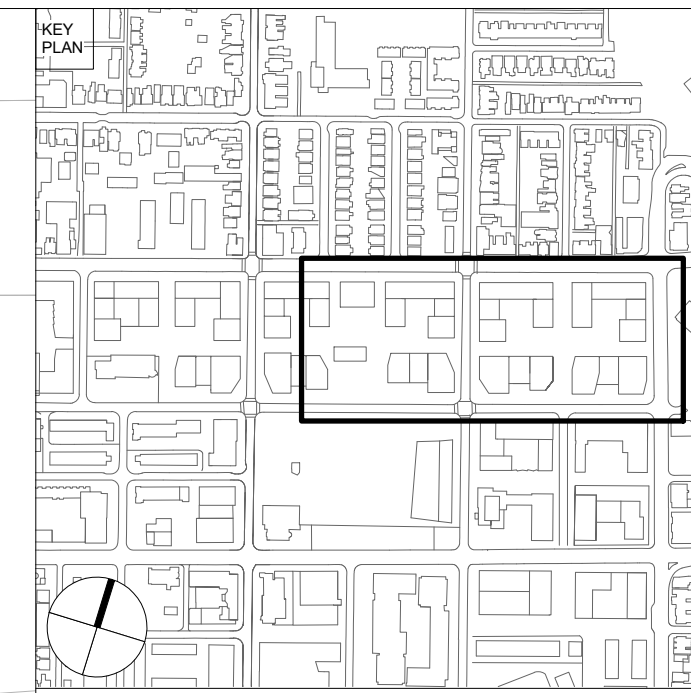

CLIENT
Toronto Community Housing Corporation (TCHC) and 2747199 Ontario Limited (Deltra Inc.)

THIS DRAWING IS BASED ON DIMENSIONAL SURVEY INFORMATION PROVIDED BY OTHERS AND REPRESENTS THE ARCHITECT'S BEST CURRENT UNDERSTANDING OF EXISTING CONDITIONS. THE ARCHITECT CANNOT ACCEPT RESPONSIBILITY FOR THE ACCURACY OF THIS SURVEY INFORMATION.
 ALL DIMENSIONS ARE SHOWN IN METRIC. DO NOT SCALE FROM THIS DRAWING.
 THIS DRAWING REMAINS THE COPYRIGHT OF KARAKUSEVIC CARSON ARCHITECTS AND MAY NOT BE USED WITHOUT THEIR EXPRESSED WRITTEN CONSENT.
 THESE DRAWINGS ARE NOT FOR CONSTRUCTION

NOTES

- Phases 4&5 Property Line
- City of Toronto Owned Lands Right of Way
- 1B
- 1B+
- 2B
- 2B+
- 3B
- 3B+
- 4B
- 5B
- Amenity
- Ancillary
- Civic
- Community
- Lobby
- Retail

P03 S4 P2 - Issued for ZBA	11/29/22
P02 S3 P2 - Draft for Client Review	11/15/22
P01 S4 P1 - Issued for ZBA	04/14/22
P00 S3 P1 - Draft for Client Review	04/01/22

Rev. Status Reason for Issue Date

ARCHITECT OF RECORD
E.R.A. Architects Inc.
 625 Church St
 Suite 600
 Toronto
 Ontario, M4Y 2G1
 info@eraarch.ca | 416 963 4497



DESIGN
Karakusevic Carson Architects
 Studio 501
 37 Cremer St
 Hackney
 London E2 8HD
 mail@karakusevic-carson.com | +44(0)207 566 6300

PROJECT
Regent Park Phases 4 & 5

TITLE
Level 05 Plan - East

DRAWING NUMBER	577 - KCA-EA-05-DR-A - 1010	REVISION	P03
STATUS	S4 - Suitable for stage approval	STAGE	P2
REVISION DATE	11/29/22	DRAWN BY	H/AJAN
FIRST ISSUED	04/01/22	CHECKED BY	PK/RM
		KCA PROJECT NUMBER	577

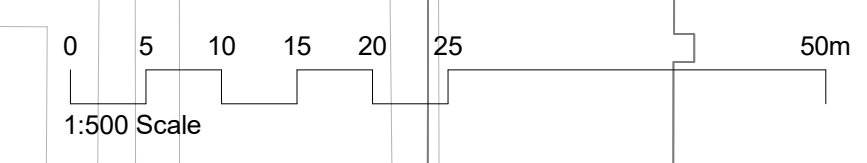



KEY PLAN

CLIENT
Toronto Community Housing Corporation (TCHC) and 2747199 Ontario Limited (Deltra Inc.)

THIS DRAWING IS BASED ON DIMENSIONAL SURVEY INFORMATION PROVIDED BY OTHERS AND REPRESENTS THE ARCHITECT'S BEST CURRENT UNDERSTANDING OF EXISTING CONDITIONS. THE ARCHITECTS CANNOT ACCEPT RESPONSIBILITY FOR THE ACCURACY OF THIS SURVEY INFORMATION.

ALL DIMENSIONS ARE SHOWN IN METRIC. DO NOT SCALE FROM THIS DRAWING.

THIS DRAWING REMAINS THE COPYRIGHT OF KARAKUSEVIC CARSON ARCHITECTS AND MAY NOT BE USED WITHOUT THEIR EXPRESSED WRITTEN CONSENT.

THESE DRAWINGS ARE NOT FOR CONSTRUCTION

NOTES

- Phases 4&5 Property Line
- City of Toronto Owned Lands Right of Way
- 1B
- 1B+
- 2B
- 2B+
- 3B
- 3B+
- 4B
- 5B
- Amenity
- Ancillary
- Civic
- Community
- Lobby
- Retail

P03	S4	P2	- Issued for ZBA	11/29/22
P02	S3	P2	- Draft for Client Review	11/15/22
P01	S4	P1	- Issued for ZBA	04/14/22
P00	S3	P1	- Draft for Client Review	04/01/22

ARCHITECT OF RECORD
E.R.A. Architects Inc.
 625 Church St
 Suite 600
 Toronto
 Ontario, M4Y 2G1
 info@eraarch.ca | 416 963 4497



DESIGN
Karakusevic Carson Architects
 Studio 501
 37 Cremer St
 Hackney
 London E2 8HD
 mail@karakusevic-carson.com | +44(0)207 566 6300

PROJECT
Regent Park Phases 4 & 5

TITLE
Level 05 Plan - West

DRAWING NUMBER	577 - KCA-WE-05-DR-A - 1010	REVISION	P03
STATUS	S4 - Suitable for stage approval	STAGE	P2
REVISION DATE	11/29/22	DRAWN BY	H/A/J
FIRST ISSUED	04/01/22	CHECKED BY	PK/RM
		KCA PROJECT NUMBER	577

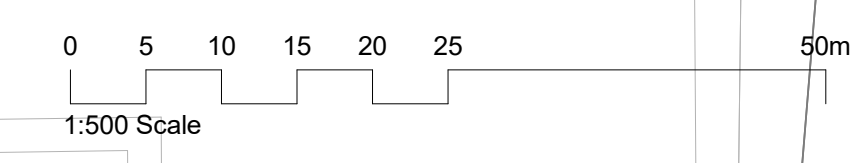

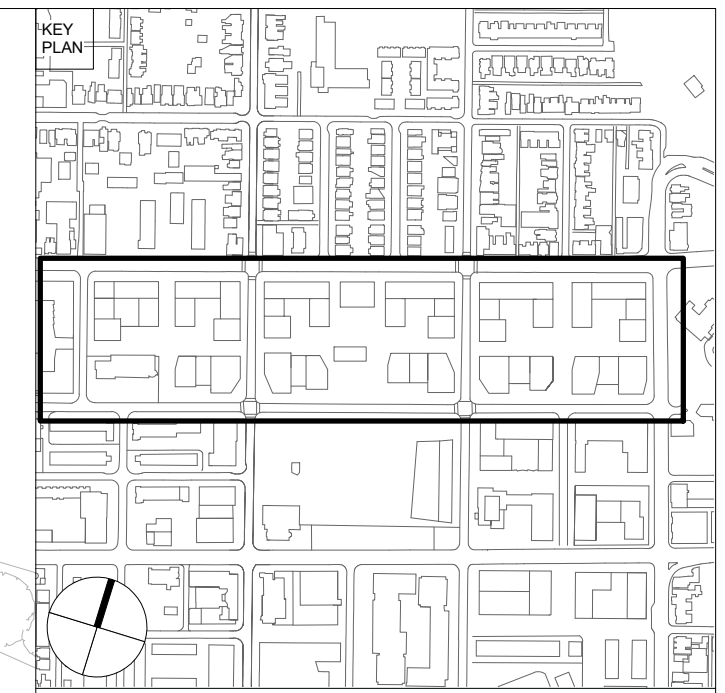
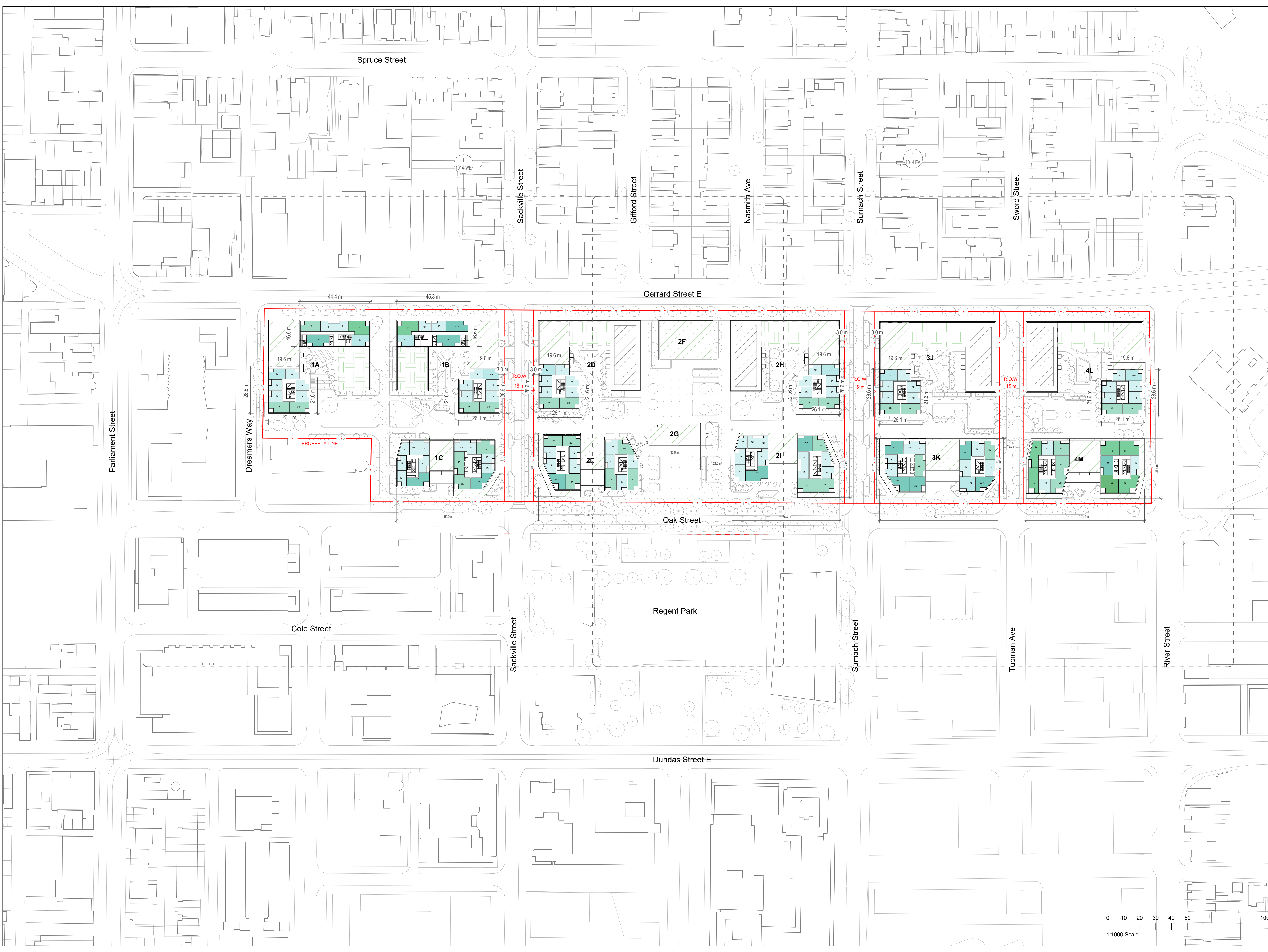

CLIENT
Toronto Community Housing Corporation (TCHC) and 2747199 Ontario Limited (Deltra Inc.)

THIS DRAWING IS BASED ON DIMENSIONAL SURVEY INFORMATION PROVIDED BY OTHERS AND REPRESENTS THE ARCHITECT'S BEST CURRENT UNDERSTANDING OF EXISTING CONDITIONS. THE ARCHITECT CANNOT ACCEPT RESPONSIBILITY FOR THE ACCURACY OF THIS SURVEY INFORMATION.
 ALL DIMENSIONS ARE SHOWN IN METRIC. DO NOT SCALE FROM THIS DRAWING.
 THIS DRAWING REMAINS THE COPYRIGHT OF KARAKUSEVIC CARSON ARCHITECTS AND MAY NOT BE USED WITHOUT THEIR EXPRESSED WRITTEN CONSENT.
THESE DRAWINGS ARE NOT FOR CONSTRUCTION

NOTES

- Phases 4&5 Property Line
- City of Toronto Owned Lands Right of Way
- Potential Outdoor Amenity
- Potential Green Roofs
- Potential Mechanical Plant

P03 S4 P2 - Issued for ZBA	11/29/22
P02 S3 P2 - Draft for Client Review	11/15/22
P01 S4 P1 - Issued for ZBA	04/14/22
P00 S3 P1 - Draft for Client Review	04/01/22
Rev. Status Reason for Issue	Date

ARCHITECT OF RECORD
E.R.A. Architects Inc.
 625 Church St
 Suite 600
 Toronto
 Ontario, M4Y 2G1
 info@eraarch.ca | 416 963 4497



DESIGN
Karakusevic Carson Architects
 Studio 501
 37 Cremer St
 Hackney
 London E2 8HD
 mail@karakusevic-carson.com | +44(0)207 566 6300

PROJECT
Regent Park Phases 4 & 5

TITLE
Level 10 Plan

DRAWING NUMBER	577 - KCA-XX-10-DR-A - 1014	REVISION	P03
STATUS	S4 - Suitable for stage approval	STAGE	P2
REVISION DATE	11/29/22	DRAWN BY	H/AJAN
FIRST ISSUED	04/01/22	CHECKED BY	PK/RM
		KCA PROJECT NUMBER	577

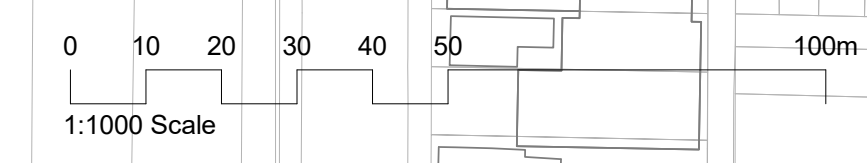

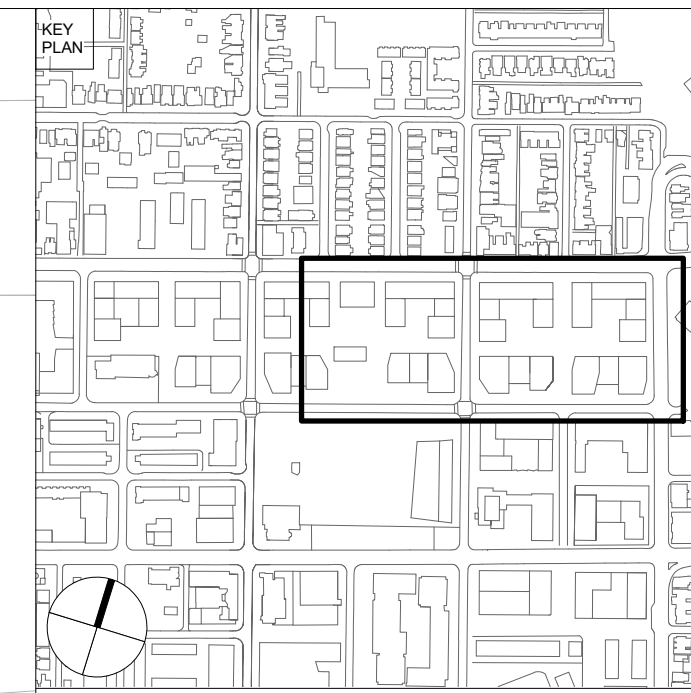

CLIENT
Toronto Community Housing Corporation (TCHC) and 2747199 Ontario Limited (Deltera Inc.)

THIS DRAWING IS BASED ON DIMENSIONAL SURVEY INFORMATION PROVIDED BY OTHERS AND REPRESENTS THE ARCHITECT'S BEST CURRENT UNDERSTANDING OF EXISTING CONDITIONS. THE ARCHITECT CANNOT ACCEPT RESPONSIBILITY FOR THE ACCURACY OF THIS SURVEY INFORMATION.
 ALL DIMENSIONS ARE SHOWN IN METRIC. DO NOT SCALE FROM THIS DRAWING.
 THIS DRAWING REMAINS THE COPYRIGHT OF KARAKUSEVIC CARSON ARCHITECTS AND MAY NOT BE USED WITHOUT THEIR EXPRESSED WRITTEN CONSENT.
 THESE DRAWINGS ARE NOT FOR CONSTRUCTION

NOTES

- Phases 4&5 Property Line
 - City of Toronto Owned Lands Right of Way
 - Potential Residential Outdoor Amenity
 - Potential Green Roofs
 - Potential Mechanical Plant
- 1B
 - 1B+
 - 2B
 - 2B+
 - 3B
 - 3B+
 - 4B
 - 5B
 - Amenity
 - Ancillary
 - Civic
 - Community
 - Lobby
 - Retail

P03 S4 P2 - Issued for ZBA	11/29/22
P02 S3 P2 - Draft for Client Review	11/15/22
P01 S4 P1 - Issued for ZBA	04/14/22
P00 S3 P1 - Draft for Client Review	04/01/22

Rev. Status Reason for Issue Date

ARCHITECT OF RECORD
E.R.A. Architects Inc.
 625 Church St
 Suite 600
 Toronto
 Ontario, M4Y 2G1
 info@eraarch.ca | 416 963 4497



DESIGN
Karakusevic Carson Architects
 Studio 501
 37 Cremer St
 Hackney
 London E2 8HD
 mail@karakusevic-carson.com | +44(0)207 566 6300

PROJECT
Regent Park Phases 4 & 5

TITLE
Level 10 Plan - East

DRAWING NUMBER 577 - KCA - EA - 10 - DR - A - 1014	REVISION P03
STATUS S4 - Suitable for stage approval	STAGE P2
REVISION DATE 11/29/22	DRAWN BY H/AJAN
FIRST ISSUED 04/01/22	CHECKED BY PK/RM
SCALE 1 : 500 @ ARCH D	KCA PROJECT NUMBER 577

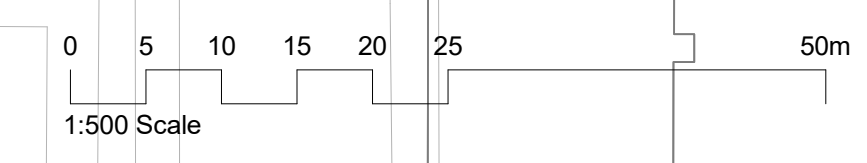

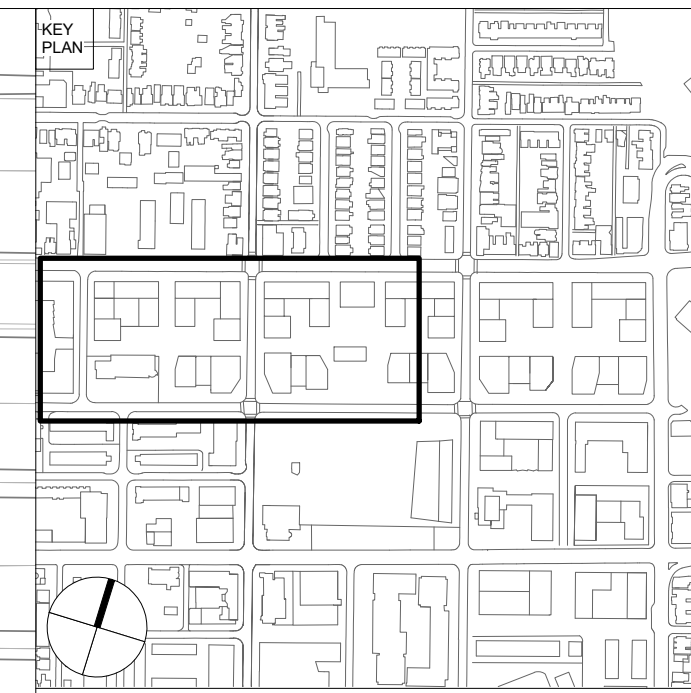
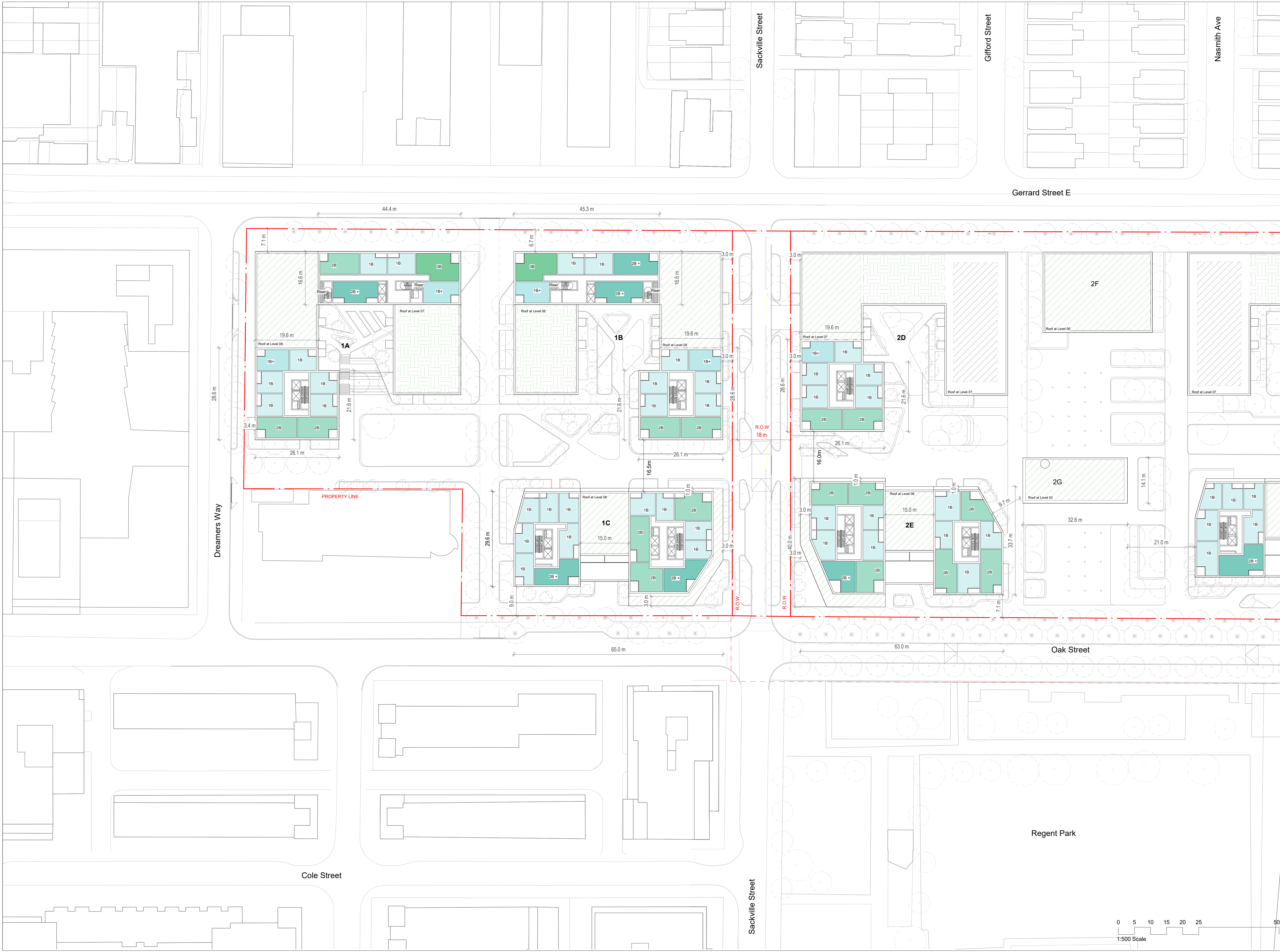

CLIENT
Toronto Community Housing Corporation (TCHC) and 2747199 Ontario Limited (Deltra Inc.)

THIS DRAWING IS BASED ON DIMENSIONAL SURVEY INFORMATION PROVIDED BY OTHERS AND REPRESENTS THE ARCHITECT'S BEST CURRENT UNDERSTANDING OF EXISTING CONDITIONS. THE ARCHITECT CANNOT ACCEPT RESPONSIBILITY FOR THE ACCURACY OF THIS SURVEY INFORMATION.
 ALL DIMENSIONS ARE SHOWN IN METRIC. DO NOT SCALE FROM THIS DRAWING.
 THIS DRAWING REMAINS THE COPYRIGHT OF KARAKUSEVIC CARSON ARCHITECTS AND MAY NOT BE USED WITHOUT THEIR EXPRESSED WRITTEN CONSENT.
 THESE DRAWINGS ARE NOT FOR CONSTRUCTION

NOTES

- Phases 4&5 Property Line
- City of Toronto Owned Lands Right of Way
- Potential Residential Outdoor Amenity
- Potential Green Roofs
- Potential Mechanical Plant
- 1B
- 1B+
- 2B
- 2B+
- 3B
- 3B+
- 4B
- 5B
- Amenity
- Ancillary
- Civic
- Community
- Lobby
- Retail

P03	S4	P2 - Issued for ZBA	11/29/22
P02	S3	P2 - Draft for Client Review	11/15/22
P01	S4	P1 - Issued for ZBA	04/14/22
P00	S3	P1 - Draft for Client Review	04/01/22

Rev. Status Reason for Issue Date

ARCHITECT OF RECORD
E.R.A. Architects Inc.
 625 Church St
 Suite 600
 Toronto
 Ontario, M4Y 2G1
 info@eraarch.ca | 416 963 4497



DESIGN
Karakusevic Carson Architects
 Studio 501
 37 Cremer St
 Hackney
 London E2 8HD
 mail@karakusevic-carson.com | +44(0)207 566 6300

PROJECT
Regent Park Phases 4 & 5

TITLE
Level 10 Plan - West

DRAWING NUMBER	577 - KCA-WE-10-DR-A - 1014	REVISION	P03
STATUS	S4 - Suitable for stage approval	STAGE	P2
REVISION DATE	11/29/22	DRAWN BY	H/A/J
FIRST ISSUED	04/01/22	CHECKED BY	PK/RM
		KCA PROJECT NUMBER	577

